

Exempt from recording fees  
 pursuant to Govt. Code 27200.9



PLACER, County Recorder  
JIM MCCAULEY Co Recorder Office  
DOC- 1999-0089842

Wednesday, OCT 13, 1999 10:19:52  
NOC \$0.00

Ttl Pd \$0.00

Nbr-0000242259

rec/R2/1-66

Recording Requested By:

AFTER RECORDING RETURN TO:  
City Clerk  
City of Roseville  
511 Tanager Street, Office 200  
Roseville, CA 95678

**DEVELOPMENT AGREEMENT**

**BY AND BETWEEN THE CITY OF ROSEVILLE AND**

**MOURIER LAND INVESTMENT CORPORATION**

**RELATIVE TO THE**

**NORTH ROSEVILLE SPECIFIC PLAN**

**Phase II**

**FILED**

**NOV 16 1999**

**CITY OF ROSEVILLE**

**BY** \_\_\_\_\_

0202 0000 0007 0028

# TABLE OF CONTENTS

	<u>Page</u>
<b>RECITALS</b> .....	1
<b>1. AUTHORIZATION</b> .....	1
<b>2. PROPERTY</b> .....	1
<b>3. HEARING</b> .....	1
<b>4. ENVIRONMENTAL IMPACT REPORT</b> .....	1
<b>5. ENTITLEMENTS</b> .....	2
<b>6. GENERAL AND SPECIFIC PLANS</b> .....	2
<b>7. SUBSTANTIAL COSTS TO LANDOWNER</b> .....	2
<b>8. NEED FOR SERVICES AND FACILITIES</b> .....	2
<b>9. CONTRIBUTION TO COSTS OF FACILITIES AND SERVICES</b> .....	2
<b>10. DEVELOPMENT AGREEMENT ORDINANCE</b> .....	3
<b>11. CONSISTENCY WITH GENERAL PLAN AND SPECIFIC PLAN</b> .....	3
<b>1. AGREEMENT</b> .....	3
<b>SECTION 1: GENERAL PROVISIONS</b> .....	3
1.1 <u>INCORPORATION OF RECITALS</u> .....	3
1.2 <u>PROPERTY DESCRIPTION AND BINDING COVENANTS</u> .....	3
1.3 <u>TERM</u> .....	3
1.3.1 <u>Commencement; Expiration</u> .....	3
1.3.2 <u>Automatic Termination Upon Completion and Sale of Residential Unit</u> .....	3
1.3.3 <u>Termination Upon Landowner Request</u> .....	4
1.4 <u>AMENDMENT OF AGREEMENT</u> .....	4
1.5 <u>RECORDATION</u> .....	4
<b>SECTION 2: DEVELOPMENT OF THE PROPERTY</b> .....	5
2.1 <u>PERMITTED USES</u> .....	5
2.2 <u>VESTED ENTITLEMENTS</u> .....	5
2.3 <u>DENSITIES AND DENSITY TRANSFER</u> .....	5
2.4 <u>RULES, REGULATIONS AND OFFICIAL POLICIES</u> .....	5
2.4.1 <u>Inconsistency</u> .....	5
2.4.2 <u>Application of Changes</u> .....	6
2.4.3 <u>Authority of City</u> .....	6
2.5 <u>CITY FEES, TAXES AND ASSESSMENTS</u> .....	6
2.5.1 <u>Processing Fees and Charges</u> .....	6
2.5.2 <u>Public Financing Limited to Specific Funding Mechanisms and Fees</u> .....	6
2.6 <u>AFFORDABLE HOUSING</u> .....	7
2.6.1 <u>Affordable Purchase Residential Units</u> .....	7

2.6.1.1 Agreement Required .....	7
2.6.1.2 Content .....	7
2.6.1.3 No City Subsidies.....	9
2.6.1.4 Transfer of Obligation.....	9
2.6.1.5 In Lieu Fee.....	9
2.7 WETLANDS .....	9
2.7.1 404 Permit.....	9
2.7.2 Maintenance by Landowner .....	10
<b>SECTION 3: LANDOWNER OBLIGATIONS .....</b>	<b>10</b>
3.1 DEVELOPMENT, CONNECTION AND MITIGATION FEES .....	10
3.2 PARKS AND OPEN SPACE.....	11
3.2.1 Dedications.....	11
3.2.2 Financing for Parks.....	11
3.2.3 Contribution to Construction of Bike Trail Improvements .....	11
3.2.4 Frontage Improvements .....	12
3.2.5 Park Fee and Reimbursement .....	12
3.2.6 Entire Park Land Obligation.....	13
3.3 SCHOOL FEE AGREEMENTS .....	13
3.4 ELECTRIC.....	13
3.4.1 Public Utilities Within Rights-of-Way .....	13
3.4.2 On-Site Electric Utility .....	14
3.4.3 Streetlights.....	14
3.4.4 Electrical Efficiency .....	14
3.5 DRAINAGE IMPROVEMENTS.....	14
3.5.1 Master Drainage Plan.....	14
3.5.2 Other Agency Approval.....	14
3.5.3 Storm Drains.....	15
3.5.4 Grant of Floodplain.....	15
3.5.5 Drainage Easements .....	15
3.6 WATER SYSTEM IMPROVEMENTS.....	15
3.6.1 Water Study .....	15
3.6.2 Financing of Water Supply.....	15
3.6.3 On-site Water Lines .....	16
3.6.4 Water System Sequencing.....	16
3.6.5 Public Utility Easements.....	16
3.6.6 Water Softeners.....	16
3.7 RECYCLED WATER .....	17
3.7.1 Recycled Water Improvements .....	17
3.7.2 Improvement Standards.....	17
3.7.3 Public Utility Easements.....	17
3.8 SEWER IMPROVEMENTS.....	17
3.8.1 Master Wastewater Plan.....	18
3.8.2 Improvement Standards.....	19
3.8.3 Access to Manholes.....	19
3.8.4 Public Utility Easements.....	19
3.8.5 Sequencing of Wastewater Improvements.....	19
3.9 ROAD IMPROVEMENTS .....	19
3.9.1 Landowner Obligations.....	20
3.9.2 Blue Oaks .....	20
3.9.3 Fiddymont Road.....	20
3.9.4 Collector Streets .....	22
3.9.5 Timing of Road Improvements.....	23
3.9.6 Road Improvement Standards.....	23

3.9.7 <u>Landscape Setbacks</u> .....	23
3.9.8 <u>Traffic Signals</u> .....	24
3.9.9 <u>Cirby-Riverside</u> .....	24
3.9.10 <u>Update of City Fee Programs</u> .....	24
3.9.11 <u>Light Rail Funding</u> .....	25
3.9.12 <u>Master Plan Funding</u> .....	25
3.9.13 <u>Transportation Systems Management</u> .....	25
3.10 <u>MISCELLANEOUS PUBLIC FACILITIES AND SERVICES</u> .....	25
3.10.1 <u>Fire Tax</u> .....	25
3.10.2 <u>County-Wide Facilities Fee</u> .....	25
3.10.3 <u>Cultural Resource Area</u> .....	25
3.11 <u>LIENS, ENCUMBRANCES, COVENANTS, CONDITIONS AND RESTRICTIONS</u> .....	26
3.12 <u>EIR MITIGATION MEASURES</u> .....	26
3.13 <u>WAIVER</u> .....	26
3.14 <u>COMMUNITY FACILITIES DISTRICT AND FINANCING</u> .....	27
3.14.1 <u>Community Facilities District</u> .....	27
3.14.2 <u>Effect of CFD Financing on Credits and Reimbursements</u> .....	27
3.15 <u>COMPLETION OF IMPROVEMENTS</u> .....	27
3.16 <u>SERVICES DISTRICT</u> .....	28
3.16.1 <u>Formation</u> .....	28
3.16.1.1 <u>Consent, Waiver and Special Benefit</u> .....	28
3.16.1.2 <u>Public Parcel Exclusion</u> .....	28
3.16.2 <u>Obligations</u> .....	28
3.16.3 <u>Encroachment Permits, Landscape Maintenance Easements</u> .....	29
<b>SECTION 4: CITY OBLIGATIONS</b> .....	<b>30</b>
4.1 <u>CITY COOPERATION</u> .....	30
4.2 <u>CREDITS AND REIMBURSEMENTS</u> .....	30
4.2.1 <u>Credits Against Fees</u> .....	30
4.2.1.1 <u>Citywide Park Fee</u> .....	30
4.2.1.2 <u>Traffic Mitigation Fee</u> .....	30
4.2.2 <u>Participation/Reimbursement By City</u> .....	30
4.2.3 <u>Reimbursement by Third Parties</u> .....	31
4.2.4 <u>Reimbursable Hard Costs</u> .....	31
4.2.5 <u>Interest on Reimbursements</u> .....	31
4.2.6 <u>Term for Credits and Reimbursements</u> .....	32
4.2.7 <u>Not a Limitation</u> .....	32
4.3 <u>APPLICATIONS FOR PERMITS AND ENTITLEMENTS</u> .....	32
4.3.1 <u>Action by City</u> .....	32
4.3.2 <u>Maps and Permits</u> .....	32
4.3.3 <u>Personnel</u> .....	32
4.4 <u>SUBDIVISION MAP ACT WAIVER</u> .....	33
4.5 <u>LIMITED WAIVER OF PROTEST RIGHTS</u> .....	33
4.6 <u>MORATORIUM, QUOTAS, RESTRICTIONS OR OTHER GROWTH LIMITATIONS</u> .....	33
4.7 <u>ESSENCE OF AGREEMENT</u> .....	33
<b>SECTION 5: DEFAULT, REMEDIES, TERMINATION</b> .....	<b>34</b>
5.1 <u>GENERAL PROVISIONS</u> .....	34
5.2 <u>ANNUAL REVIEW</u> .....	34
5.3 <u>ENFORCED DELAY, EXTENSION OF TIMES OF PERFORMANCE</u> .....	35
5.4 <u>LEGAL ACTION</u> .....	35
5.5 <u>EFFECT OF TERMINATION</u> .....	35
5.6 <u>APPLICABLE LAW AND ATTORNEYS' FEES</u> .....	36

<b>SECTION 6: HOLD HARMLESS AGREEMENT .....</b>	<b>36</b>
<b>SECTION 7: PROJECT AS A PRIVATE UNDERTAKING .....</b>	<b>36</b>
<b>SECTION 8: COOPERATION IN THE EVENT OF LEGAL CHALLENGE.....</b>	<b>37</b>
<b>SECTION 9: GENERAL.....</b>	<b>37</b>
<b>9.1 <u>ENFORCEABILITY</u>.....</b>	<b>37</b>
9.2 <u>CITY FINDING</u> .....	37
9.3 <u>THIRD PARTY BENEFICIARIES</u> .....	37
9.4 <u>SEVERABILITY</u> .....	37
9.5 <u>CONSTRUCTION</u> .....	37
9.6 <u>OTHER NECESSARY ACTS</u> .....	37
9.7 <u>ESTOPPEL CERTIFICATE</u> .....	38
<b>SECTION 10: NOTICES.....</b>	<b>38</b>
<b>2. ASSIGNMENT.....</b>	<b>39</b>
<b>3. FORM OF AGREEMENT, EXHIBITS.....</b>	<b>39</b>

**DEVELOPMENT AGREEMENT  
BY AND BETWEEN THE CITY OF ROSEVILLE AND  
MOURIER LAND INVESTMENT CORPORATION  
RELATIVE TO THE  
NORTH ROSEVILLE SPECIFIC PLAN  
Phase II**

This Development Agreement is entered into this 22nd day of September, 1999, by and between the **CITY OF ROSEVILLE**, a municipal corporation, hereinafter "City", and **MOURIER LAND INVESTMENT CORPORATION**, a California corporation, hereinafter "Landowner", pursuant to the authority of Sections 65864 through 65869.5 of the Government Code of California.

**Recitals**

1. Authorization. To strengthen the public planning process, encourage private participation in comprehensive planning and reduce the economic risk of development, the Legislature of the State of California adopted Section 65864, et seq., of the Government Code (the "Development Agreement Statute"), which authorizes the City of Roseville and an applicant for a development project to enter into a development agreement, establishing certain development rights in the Property which is the subject of the development project application.

2. Property. The subject of this Agreement is the development of those certain parcels of land, consisting of approximately 161 acres located in the City of Roseville, County of Placer, as described in **Exhibit A-1**" and shown on **Exhibit A-2**" (hereinafter the "Property"), attached hereto and incorporated herein by this reference. Landowner represents that it owns the Property in fee and that all persons holding legal or equitable interests in the Property shall be bound by the Agreement.

3. Hearing. On April 15, 1999, the City Planning Commission, designated by Roseville Ordinance No. 3014 as the planning agency for purposes of development agreement review pursuant to Government Code Section 65867, in a duly noticed and conducted public hearing, considered this Agreement and recommended that the City Council approve this Agreement.

4. Environmental Impact Report. On 8/6/97, the City Council, in Resolution 97-211, certified as adequate and complete the Final EIR (the "Plan EIR") for the North Roseville Specific Plan (the "Specific Plan"). On May 19, 1999, the City Council, in Resolution No. 99-183, certified as adequate and complete the Final Subsequent EIR (the "Subsequent EIR") for Phase II of the North Roseville Specific Plan. Mitigation measures were suggested in the Plan EIR and the Subsequent EIR and are incorporated to the extent feasible in the Specific Plan and in the terms and conditions of this Agreement, as reflected by the findings adopted by the City Council concurrently with this Agreement.

0202 0000 0007 0033 6

5. Entitlements. The City Council has approved the following land use entitlements for the Property, which entitlements are the subject of this Agreement:

5.1 The Roseville General Plan, as amended by Resolution No. 99-186 ;

5.2 The North Roseville Specific Plan and Design Guidelines, as adopted by Resolution No. 99-187 (the "Specific Plan")

5.3 The Rezoning of the Property pursuant to Ordinance No. 3357, dated June 2, 1999; and

5.4 This Development Agreement, as adopted by Ordinance No. 3358 (the "Adopting Ordinance").

The approvals described in paragraphs A through C, inclusive, are referred to herein as the "Entitlements."

6. General and Specific Plans. Development of the Property in accordance with the Entitlements and this Agreement will provide orderly growth and development of the area in accordance with the policies set forth in the General and Specific Plans. For purposes of the vesting protection granted by this Agreement, except as otherwise provided herein, the applicable law shall be as set forth in the Entitlements as of the date hereof.

7. Substantial Costs to Landowner. Landowner has incurred and will incur substantial costs in order to comply with conditions of approval of the Entitlements and to assure development of the Property in accordance with the Entitlements and the terms of this Agreement.

8. Need for Services and Facilities. Development of the Property will result in a need for municipal services and facilities, which services and facilities will be provided by City to such development subject to the performance of Landowner's obligations hereunder.

9. Contribution to Costs of Facilities and Services. Landowner agrees to contribute to the costs of such public facilities and services as required herein to mitigate impacts on the community of the development of the Property, and City agrees to provide such public facilities and services to assure that Landowner may proceed with and complete development of the Property in accordance with the terms of this Agreement. City and Landowner recognize and agree that but for Landowner's contributions to mitigate the impacts arising as a result of development entitlements granted pursuant to this Agreement, City would not and could not approve the development of the Property as provided by this Agreement and that, but for City's covenant to provide the facilities and services necessary for development of the Property, Landowner would not and could not commit to provide the mitigation as provided by this Agreement. City's vesting of the right to develop the Property as provided herein is in reliance upon and in consideration of Landowner's agreement to make contributions toward the cost of

0202 0000 0007 0034 7

public improvements as herein provided to mitigate the impacts of development of the Property as such development occurs.

10. Development Agreement Ordinance. City and Landowner have taken all actions mandated by and fulfilled all requirements set forth in the Development Agreement Ordinance of the City of Roseville, Article V, Chapter 19.84 of Ordinance No. 3014 of the Roseville Municipal Code.

11. Consistency with General Plan and Specific Plan. Having duly examined and considered this Agreement and having held properly noticed public hearings hereon, the City finds and declares that this Agreement is consistent with the General Plan of the City of Roseville and with the Specific Plan.

## 1. AGREEMENT

### SECTION 1: GENERAL PROVISIONS

1.1 Incorporation of Recitals. The Preamble, the Recitals and all defined terms set forth in both are hereby incorporated into this Agreement as if set forth herein in full.

1.2 Property Description and Binding Covenants. The Property is that property described in Exhibits "A-1" and "A-2". It is intended and determined that the provisions of this Agreement shall constitute covenants which shall run with the Property and the benefits and burdens hereof shall bind and inure to all successors in interest to and assigns of the parties hereto. Accordingly, all references herein to "Landowner" shall mean and refer to Sammis Roseville Associates and each and every subsequent purchaser or transferee of the Property or any portion thereof from Landowner.

#### 1.3 Term.

1.3.1 Commencement; Expiration. The term of this Agreement shall commence upon the effective date of the Adopting Ordinance approving this Agreement and shall extend for a period of twenty (20) years thereafter, unless said term is terminated, modified or extended by circumstances set forth in this Agreement or by mutual consent of the parties hereto. Following the expiration of the term, this Agreement shall be deemed terminated and of no further force and effect; provided, however, said termination of the Agreement shall not affect any right or duty emanating from City entitlements on the Property approved concurrently with or subsequent to the approval of this Agreement.

1.3.2 Automatic Termination Upon Completion and Sale of Residential Unit. This Agreement shall automatically be terminated, without any further action by either party or need to record any additional document, with respect to any single-family residential lot within a parcel designated by the Specific Plan for residential use, upon completion of construction and issuance by the City of a final inspection for a dwelling unit upon such residential lot and

0202 0000 0007 0035 8

conveyance of such improved residential lot by Landowner to a bona-fide good-faith purchaser thereof. In connection with its issuance of a final inspection for such improved lot, City shall confirm that: (i) all improvements which are required to serve the lot, as determined by City, have been accepted by City; (ii) the lot is included within the Services District required by Section 3.16, or other financing mechanism acceptable to the City, to the extent required hereby; and (iii) if and to the extent applicable to such lot, an affordable purchase or rental housing agreement has been recorded on the lot. This termination of this Agreement for any such residential lot as provided for in this Section 1.3.2 shall not in any way be construed to terminate or modify any assessment district or Mello-Roos Community Facilities District lien affecting such lot at the time of termination.

**1.3.3 Termination Upon Landowner Request.** This Agreement may also be terminated, at the election of the then property owner, with respect to any legally subdivided parcel designated by the Specific Plan for residential or non-residential use (other than parcels designated for public use), when recording a final residential lot subdivision map for such parcel, or receiving a certificate of occupancy or final inspection, whichever is applicable, for a multi-family or non-residential building within such parcel, by giving written notice to City of its election to terminate the Agreement for such parcel, provided that: (i) all improvements which are required to serve the parcel, as determined by City, have been accepted by City; (ii) the parcel is included within the Services District required by Section 3.16, or other financing mechanism acceptable to the City, to the extent required hereby; and (iii) with respect to residential parcels, an affordable purchase or rental housing agreement, if required for such parcel pursuant to Section 2.6, has been recorded on the parcel. City shall cause any written notice of termination approved pursuant to this subsection to be recorded against the applicable parcel, at Landowner's expense, with the County Recorder.

**1.4 Amendment of Agreement.** This Agreement may be amended from time to time by mutual consent of City and Landowner (and/or any successor owner of any portion of the Property, to the extent subject to or affected by the proposed amendment), in accordance with the provisions of the Development Agreement Statute. If the proposed amendment affects less than the entire Property, then such amendment need only be approved by the owner(s) in fee of the portion(s) of the Property that is subject to or affected by such amendment. The parties acknowledge that under the City Zoning Code and applicable rules, regulations and policies of the City, the Planning Director has the discretion to approve minor modifications to approved land use entitlements without the requirement for a public hearing or approval by the City Council. Accordingly, the approval by the Planning Director of any minor modifications to the Entitlements which are consistent with this Agreement shall not constitute nor require an amendment to this Agreement to be effective.

**1.5 Recordation.** Except when this Agreement is automatically terminated due to the expiration of the Term or the provisions of Section 1.3.2 above, the City shall cause this Agreement, any amendment hereto and any other termination thereof to be recorded, at Landowner's expense, with the County Recorder within ten (10) days of the Agreement, amendment or termination becoming effective. Any amendment or termination of the

0202 0000 0007 0036

Agreement to be recorded that affects less than all the Property shall describe the portion thereof that is the subject of such amendment or termination.

## SECTION 2: DEVELOPMENT OF THE PROPERTY

2.1 Permitted Uses. The permitted uses of the Property, the density and intensity of use, the maximum height and size of proposed buildings, provisions for reservation or dedication of land for public purposes, and location of public improvements, and other terms and conditions of development applicable to the Property shall be those set forth in the Entitlements and this Agreement.

2.2 Vested Entitlements. Subject to the provisions and conditions of this Agreement, City agrees that City is granting, and grants herewith, a fully vested entitlement and right to develop the Property in accordance with the terms and conditions of this Agreement and the Entitlements. City acknowledges that the Entitlements include the following land uses and approximate acreage's for the Property:

Single-Family, Low Density Residential	452 units on 103.4 acres;
Park	13.4 acres;
Open Space	35.6 acres; and
Other Public (ROW)	8.6 acres.

all as set forth in Exhibit "B." Such uses shall be developed in accordance with the Entitlements, as such Entitlements provide on the effective date of this Agreement. Landowner's vested right to proceed with the development of the Property shall be subject to subsequent approvals, provided that any conditions, terms, restrictions and requirements for such subsequent approvals shall not prevent development of the Property for the uses, or reduce the density and intensity of development, or limit the rate or timing of development set forth in this Agreement, so long as Landowner is not in default under this Agreement.

2.3 Densities and Density Transfer. The number of residential dwelling units planned for the parcels within a Neighborhood of the Specific Plan may be transferred between such parcels, subject to compliance with the conditions for such transfer as set forth in the Specific Plan.

### 2.4 Rules, Regulations and Official Policies.

2.4.1 Inconsistency. To the extent any future rules, ordinances, regulations or policies applicable to development of the Property are inconsistent with the permitted uses, density and intensity of use, rate or timing of construction, maximum building height and size, or provisions for reservation and dedication of land under the Entitlements as provided in this Agreement, the terms of the Entitlements and this Agreement shall prevail, unless the parties mutually agree to alter this Agreement. To the extent any future rules, ordinances, fees, regulations or policies applicable to development of the Property are not inconsistent with the

0202 0000 0007 0037 10

permitted uses, density and intensity of use, rate or timing of construction, maximum building height and size, or provisions for reservation or dedication of land under the Entitlements or under any other terms of this Agreement, such rules, ordinances, fees, regulations or policies shall be applicable.

2.4.2 Application of Changes. This section shall not preclude the application to development of the Property of changes in City laws, regulations, plans or policies, the terms of which are specifically mandated and required by changes in State or Federal laws or regulations. To the extent that such changes in City laws, regulations, plans or policies prevent, delay or preclude compliance with one or more provisions of this Agreement, City and Landowner shall take such action as may be required pursuant to Section 4.1 of this Agreement to comply therewith.

2.4.3 Authority of City. This section shall not be construed to limit the authority or obligation of City to hold necessary public hearings, or to limit discretion of City or any of its officers or officials with regard to rules, regulations, ordinances, laws and entitlements of use which require the exercise of discretion by City or any of its officers or officials, provided that subsequent discretionary actions shall not prevent or delay development of the Property for the uses and to the density and intensity of development as provided by the Entitlements and this Agreement, in effect as of the effective date of this Agreement.

## 2.5 City Fees, Taxes and Assessments

2.5.1 Processing Fees and Charges. Landowner shall pay those processing, inspection and plan checking fees and charges required by City under then current regulations for processing applications and requests for permits, approvals and other actions, and monitoring compliance with any permits issued or approvals granted or the performance of any conditions with respect thereto or any performance required of Landowner hereunder.

2.5.2 Public Financing Limited to Specific Funding Mechanisms and Fees. This Agreement includes specific construction, funding and reimbursement obligations of Landowner and specific obligations to participate in a community facilities district(s) or a similar financing district to fund the acquisition and construction of specific facilities and the maintenance of certain improvements. Landowner's obligation with respect to the participation of the Property in any funding mechanisms to support the construction of any other public facilities and improvements or the provision of public services in relation to development of the Property shall be to pay City fees related to the construction and provision of such public facilities authorized by ordinance to be collected by City as of the effective date of this Agreement as such fees may be adjusted from time to time in accordance with applicable law, or such other fees as may be duly adopted in the future by City from time to time in accordance with applicable law; provided, however, Landowner's obligation to pay future City fees is limited to those fees adopted on a City-wide basis or which apply uniformly to all properties within the City of Roseville which are zoned consistent with Landowner's zoning as set forth in the Entitlements, or which apply uniformly to all properties which are similarly situated, whether by geographic location, drainage sheds or other distinguishing circumstances.

0202 0000 0007 0038 11

2.6 Affordable Housing. Consistent with the goals and policies contained in City's General Plan and the Specific Plan, and subject to the terms of this Agreement, Landowner shall develop or cause ten percent (10%) of the total residential units which are actually constructed within its Property to be developed as affordable housing. In accordance with the terms of this Section and subject to adjustment based on actual development, the goal is to provide 34 units affordable for purchase to low-income households, and 11 units affordable for purchase to middle-income households. Any adjustment based on actual development shall be subject to the approval of the Housing Director.

The terms "very low income" means households earning less than fifty percent (50%) of median income, "low income" means households earning fifty-one percent (51%) to eighty percent (80%) of median income, and "middle income" means households earning eighty-one percent (81%) to one hundred percent (100%) of median income. Median income and allowable assets shall be determined in accordance with the General Plan Housing Element, the Specific Plan, and City policy.

2.6.1 Affordable Purchase Residential Units. Landowner agrees that 34 single-family residential units will be reserved within Parcel W-2 as detached and/or attached single-family residential units affordable to purchasers in low-income households, and 11 residential units will be reserved within Parcel W-2 as detached and/or attached single-family residential units affordable to middle-income purchasers. Such units shall be distributed throughout the applicable Parcel.

2.6.1.1 Agreement Required. Prior to the approval of each final residential lot subdivision map within a Parcel designated to provide affordable purchase opportunities, the parties shall enter into City's then current form Affordable Purchase Housing Development Agreement (or other form as required by the City) for the residential purchase units affordable to low-income households and affordable to middle-income households.

2.6.1.2 Content. The Affordable Purchase Housing Development Agreements shall, for each such residential lot subdivision, set forth, among other things, the distribution of the relevant number of said affordable housing units within the subdivision, Landowner's obligations for marketing the affordable units, and sharing of appreciation (if any) of the affordable unit's value. No City subsidies will be required to be made available to provide residential purchase units affordable to middle-income or low-income households.

Notwithstanding any provisions of the City's then current Affordable Purchase Housing Development Agreement to the contrary, the Affordable Purchase Housing Development Agreements shall provide that:

- a) For purposes of low-income affordable purchase units, "low-income" shall mean households earning seventy percent (70%) to eighty percent (80%) of median income.

12

0202 0000 0007 0039

b) Low-income affordable purchase units shall be marketed to low-income households for a minimum of fifty (50) days from the date Landowner commences marketing of the subdivision in which such affordable units are located. Affordable purchase units marketed to low-income households which are not sold within such fifty (50) days shall be marketed for ten (10) additional days to middle-income households. If such units are not sold within the ten (10) additional days to middle-income households, the units may be sold as market price units.

Middle-income affordable purchase units shall be marketed to middle-income households for a minimum of ten (10) days from the date Landowner commences marketing of the subdivision in which such affordable units are located. If not sold to middle-income households within that period, the units may be sold as market price units.

Any affordable purchase units remaining unsold after the required marketing periods as either low- or middle-income units which are later sold as market units shall nonetheless be credited against Landowner's affordable purchase housing obligation.

c) The Landowner may develop the affordable purchase units with fewer amenities than the market rate units, however, the affordable purchase units shall utilize the same or similar materials as the market rate units on the exterior.

d) Landowner's obligation to provide affordable purchase units may be moved and may be satisfied by the provision of affordable purchase units elsewhere within the applicable subdivision, or within other residential Parcels within the Neighborhood, or within residential Parcels within other Neighborhoods of the Specific Plan (including, but not limited to, Phase I of the Specific Plan), subject to the Housing Director's approval.

e) For purposes of making housing opportunities affordable, Landowner agrees that it shall use its best efforts to sell such affordable purchase units to qualifying low- or middle-income households as the case may be as required by this Agreement. Such best efforts shall include, without limitation, special advertising prior to the release of the affordable purchase units for sale indicating the availability thereof to low- or middle-income households, and maintenance of a waiting list of low- or middle-income households seeking housing opportunities in Landowner's development(s), notification of such persons (and any such households provided by the Housing and Redevelopment Manager for the City) prior to any release of affordable purchase units, and the pre-release, by at least one day, of such affordable purchase units to such notified households.

Within three (3) working days of execution of a contract of sale of an affordable purchase unit to a qualifying low- or middle-income household, Landowner

13

0202 0000 0007 0040

shall notify the Housing and Redevelopment Manager in writing of such sale and provide information verifying such qualification as low- or middle-income.

f) The Housing Director shall maintain a list of low-income affordable purchase units that are conveyed and whose ownership is being maintained under an Affordable Purchase Agreement and, on or about May 1 of each calendar year, shall send a copy thereof to the City Finance Director. In reliance thereon, when determining the special taxes to be levied each year by the CFD and the Services District, to the extent permitted by law as expressed through an opinion of the City's bond counsel, the Finance Director shall set the special tax for the low-income affordable purchase units within each Parcel equal to fifty percent (50%) of the special tax for the balance of the units within said Parcel.

g) To ensure proper maintenance of each affordable purchase unit on Parcel W-2 during the term of its reservation as an affordable purchase unit, Landowner shall provide evidence to the Housing Director of arrangements for professional management of such units, or shall establish CC&Rs or a homeowners' association for such Parcels within which the affordable purchase units are located to establish a mechanism for maintaining the appearance of such affordable purchase units or provide such alternative mechanism that is acceptable to City.

2.6.1.3 No City Subsidies. Landowner agrees to provide all of the middle-income and low-income affordable purchase units without any subsidy from the City.

2.6.1.4 Transfer of Obligation. At the request of Landowner, the affordable purchase housing obligation (or any portion thereof) for Parcel W-2 may be transferred, with the consent of City, to another parcel (the Transferee Parcel) within said Parcel's Neighborhood of the Specific Plan or within another Neighborhood of the Specific Plan. No such transfer shall require an amendment to this Agreement, but City and Landowner shall execute an instrument memorializing such transfer of obligation which shall be recorded against the affected Parcels, with reference to this Agreement.

2.6.1.5 In Lieu Fee. With the consent of the City, or in the event an in-lieu affordable housing fee is adopted by the City, Landowner shall be permitted to satisfy all or a portion of its affordable housing obligations hereunder through payment of such fee.

## 2.7 Wetlands.

2.7.1 404 Permit. Landowner has obtained verification from the U.S. Army Corps of Engineers that approximately 6.45 acres of wetlands exist on the Property. Landowner shall obtain from the U. S. Army Corps of Engineers (the "Army Corps") a permit (the "404 Permit") to fill a portion of such wetlands (approximately 2.99 acres) in conjunction with development of the Property. Landowner intends to mitigate the impacts of such wetland fills through purchase of wetland mitigation credits in an off-site wetland mitigation bank.

0202 0000 0007 0041 14

When submitting its permit application to the Army Corps, Landowner shall send a copy thereof to the City and keep City informed regarding its progress of obtaining approval of such 404 Permit from applicable governmental agencies. Landowner acknowledges the City's right and intention to notify the Army Corps, either orally or in writing, of the City's intended 72" trunk sewer line and related maintenance road and bike trail through Pleasant Grove Creek. City and Landowner shall cooperate with each other in processing their respective permit applications to achieve their respective goals and objectives. The approval of Landowner's 404 Permit shall be obtained, with conditions satisfactory to the City, prior to commencement of construction of any improvements on the Property. If any conditions of the 404 Permit conflict, in any material manner, with the Entitlements related thereto, the proposal shall be resubmitted to City for review.

It is anticipated that the 404 Permit will require preservation of certain areas within the Property ("Environmental Preserves"). Upon formation of the Services District or establishment of the endowment fee financing mechanism (provided for in Section 3.16), with the authority to assume the costs of maintaining the Environmental Preserves in accordance with the 404 Permit, and upon recordation of the first residential lot subdivision map within the Property, Landowner shall convey to the City and City shall accept the Parcels comprising the Environmental Preserves. Prior to the City's acceptance of such Parcels, all restrictions imposed thereon by the 404 Permit shall be subject to the review and approval of the City, which shall not be unreasonably withheld, and Landowner shall have completed any improvements thereto that are required by the 404 Permit (e.g. fencing of areas).

**2.7.2 Maintenance by Landowner.** Landowner shall be solely responsible for satisfying all monitoring, reporting and, at the expense of the Services District or endowment fund, maintenance requirements under the 404 Permit during the remaining and any extended monitoring period, as determined by the Corps, for such Environmental Preserves. Furthermore, during said monitoring period, Landowner shall indemnify, defend and hold City harmless from any and all costs, liabilities or damages for which the City is held responsible or alleged to be responsible under the 404 Permit, as amended, which arise out of or relate to any failure of Landowner to satisfy such monitoring requirements, excluding any such failure caused by the active negligence of City or any employees, agents or contractors thereof. City acknowledges and agrees that any proposed use or improvement of the Environmental Preserves will be subject to the provisions of the 404 Permit. Landowner shall obtain all amendments to the 404 Permit which are or may be required in order to install the improvements specified in this Agreement in the Environmental Preserves.

### **SECTION 3: LANDOWNER OBLIGATIONS**

**3.1 Development, Connection and Mitigation Fees.** Except as otherwise provided herein, any and all required payments of development, connection or mitigation fees by Landowner shall be made at the time and in the amount specified by then applicable City ordinances, either in effect as of the date of this Agreement subject to adjustment, or as may subsequently be adopted, in accordance with the provisions of Section 2.5.2 above. Wherever

0202 0000 0007 0042 15

this Agreement obligates "Landowner" to design, construct or install any improvements, the cost thereof may be provided by Landowner or by the CFD or other such financing mechanism, subject to and in accordance with the provisions thereof.

3.2 Parks and Open Space. Landowner shall dedicate to City certain park and open space lands, pay fees for construction for park improvements and, construct park improvements, all as set forth herein

3.2.1 Dedications. Landowner shall dedicate a total of 49.0 acres including both active and passive use park acres. The dedications of park acreage are shown on **Exhibit "B"**. The dedications of open space shall be made at the same time as Landowner dedicates the Environmental Preserves pursuant to Section 2.7 above. Upon request of City, Landowner shall dedicate the park site or sites within the Property included in such request, provided the large-lot subdivision map for the Property dividing said park site(s) from the Property has then been recorded.

3.2.2 Financing for Parks. The construction of the park sites and Landowner's contribution for the bike trails within Phase II of the Plan Area shall be financed from CFD financing and the City's neighborhood and city-wide park fees as provided herein. Landowner agrees to pay such fees, as, when and in the amounts required thereby.

Furthermore, Landowner agrees to fund its share of the Phase II advances of (i) 1.5 million for the Mahany Park Community Center (the "Community Center Advance") and (ii) 500,000 for Mahany Park Little League improvements (the "Little League Advance"). Landowner's share of such advances shall be (i) \$298,581 and (ii) \$99,527, respectively. Landowner's share of the Community Center Advance shall be due on June 30, 2000 and its share of the Little League Advance shall be due upon the first sale of CFD bonds secured by the Property, but in no event later than December 31, 1999. Landowner's share of the Little League Advance shall be included in the CFD and its share of the Community Center Advance may be included, at Landowner's option, in the CFD; in either case, if Landowner is obligated to fund its share of an Advance(s) in cash prior to the issuance of the first bond sale for the Property, then Landowner shall have the right to be reimbursed from the CFD for such cash advance upon the later CFD bond sale. If Landowner elects not to include its share of the Community Center Advance within the CFD, then Landowner shall provide alternative security acceptable to the City Attorney for its share of such Advance prior to its recordation of the first residential-lot subdivision map within the Property. Landowner's funding of its share of the Community Center Advance shall be creditable against the Citywide Park Fee, in accordance with Section 4.2 below.

3.2.3 Contribution to Construction of Bike Trail Improvements. Landowner shall fund, as part of the payment of its neighborhood park fee described in Section 3.2.5 below, the sum of One Hundred Eleven Thousand Two Hundred Twenty-Seven Dollars (\$111,227.00) towards the cost for the City to design, secure necessary permits and construct the bike trail improvements through Pleasant Grove Creeks (Section HH, as shown on **Exhibit "C"** hereto). The City shall use such funds, together with other sewer construction funds, if necessary, to construct the bike trail, which shall also serve as the maintenance road for access to the new

trunk sewer to be located within Pleasant Grove Creek. The City shall construct such bike trail in a timely manner after completion of such trunk sewer through this portion of Pleasant Grove Creek.

The bike trail/maintenance road shall be designed by the City in accordance with either (i) the City's design standards for off-street bike trails, including Construction Standard Details CST LS-20 and CST LS-24 of the City's Construction Standards or (ii) its construction standards for wastewater maintenance road purposes, whichever is more rigorous. In consideration of the foregoing contribution by Landowner through its payment of park fees, City shall be responsible for all costs associated with the design and construction of the bike trail, including the costs of preparing the required plans and drawings therefor and securing all necessary permits therefor, including any 404 Permit or streambed alteration permits. Since the City's maintenance of the sewer line will require the regular use of heavy-duty vehicles over the maintenance road, the City shall be solely responsible for the costs to repair and/or maintain this maintenance road/bike trail.

**3.2.4 Frontage Improvements.** When installing road improvements adjacent to a park site, Landowner shall construct the frontage improvements therefor (excluding landscaping and sidewalks) and stub utilities for the park site, subject to direction from the City on the location of such utility stubs.

**3.2.5 Park Fee and Reimbursement.** In accordance with the park financing plan, the parties acknowledge and agree that (i) the neighborhood park fee required to finance the park improvements within the Plan Area would be \$1,662 per single-family residential unit, \$1,108 per multi-family residential unit and \$945 per senior residential unit within the Property, (ii) Landowner's agreement to install the park frontage improvements for the park sites generates a per-unit credit of \$167 per single-family residential unit, \$112 per multi-family residential unit and \$95 per senior residential unit within the Property, and (iii) therefore, the neighborhood park fee, net of credit, shall initially be as follows, subject to annual adjustment based on any change in the Engineering News Record, Construction Cost Index for the United States, 20-city average (or comparable replacement index; hereafter, the "ENR Construction Cost Index"):

**\$1,495 per single-family residential unit;  
\$996 per multi-family residential unit; and  
\$850 per senior residential unit within the Property.**

In consideration of Landowner's design and installation of the bike trail improvements pursuant to Section 3.2.3, unless the costs of such improvements are reimbursed by the CFD, Landowner or its successor, whoever installs such improvements, shall be reimbursed from the neighborhood park fee an amount equal to the actual cost incurred by the installing party therefor, as reasonably approved by the City, or the amount budgeted for such improvements by the park financing plan, whichever is less. Such reimbursement shall be paid by the City in accordance with Section 4.2.2 below.

0202 0000 0007 0044<sup>(1)</sup>

3.2.6 Entire Park Land Obligation. The City agrees that the provisions of the Specific Plan and the commitments contained herein satisfy the General Plan park obligations for the dedication of neighborhood/community and City-wide parks and open space related to development of the Property.

3.3 School Fee Agreements. Landowner has entered into separate written agreements with the Roseville School District and the Roseville Joint Union High School District to mitigate the impacts of development of the Property on said school districts. From and after execution thereof, City agrees that so long as Landowner is not in default of said agreements, City shall not refrain from approving any subdivision maps or other such entitlements for the Property or from issuing any building permits for development thereof consistent with the Entitlements on the basis of adverse impacts of such development on school facilities. Landowner agrees that a default under either of these school agreements shall also constitute a default under this Agreement with the City. Either School District may request that the City join in its agreement with Landowner to evidence the City's support thereof and the City will cooperate therewith and join in either school agreement as an additional party thereto, subject to its approval of the terms and conditions thereof.

3.4 Electric. Landowner shall provide electric utility improvements as provided in this section.

3.4.1 Public Utilities Within Rights-of-Way. All public utilities shall be located within the rights-of-way to be granted by Landowner to City for the arterials, collectors and other local streets within the Property or within public easements granted by Landowner to City for such purposes. Accordingly, upon approval of the final large lot subdivision map (or any phase of it), or demand of the City based upon service needs (which may include needs generated by other development within the Plan Area), whichever occurs first, Landowner agrees to grant and convey to City the rights-of-way for any arterials, collectors, local streets, or public easements that include the area within which such public utilities will be located. If such utilities need to be installed prior to the construction of the applicable street(s), Landowner shall grant a temporary public utility easement which shall merge with the rights-of-way upon completion of the applicable street improvements. The width of the rights-of-way, including the area for utilities, for the applicable roadways shall be as shown in the Specific Plan.

Landowner shall also grant and convey to City with each of the foregoing roadway easements a non-exclusive, co-extensive easement for sidewalk/pedestrian egress purposes. Each such easement shall be as depicted in the Specific Plan and shall be located within right-of-way for the adjacent roadway as shown in the Plan.

Nothing in this Agreement shall be construed to limit or restrict the right of the City to require the dedication of an easement for utility purposes related to development of any parcel when such requirement would be otherwise consistent with the reasonable exercise of the police powers of the City and is reasonably related to a requirement to serve the parcel or parcels adjacent to the easement.

0202 0000 0007 0045<sup>6</sup>

Landowner shall include a notice in the project CC&R's and its sales documentation advising property owners adjacent to the public utility easements in which 60kV overhead lines may be constructed (as shown on **Exhibit "D"**) that the City may utilize portions of these easements to construct 60kV overhead electric lines.

3.4.2 On-Site Electric Utility. Concurrently with the construction of the adjacent roadways, Landowner agrees to construct, or finance the construction of on-site electric distribution facilities required to provide electric service to the Property as directed by the Electric Utility Director as shown on **Exhibit "D"** attached hereto. The parties agree that **Exhibit "D"** is conceptual and preliminary in nature and that Landowner will construct or finance construction of electric distribution facilities in accordance with final on-site electric distribution designs for the Property as directed by the Electric Utility Director in accordance with applicable City of Roseville Electric Utility Department Specifications for such construction. Final on-site electric utility improvements including street lights, will be designed upon receipt of approved and adopted improvement plans for the applicable Plan Area roadways.

3.4.3 Streetlights. Except for Fiddymont Road, concurrently with the construction of the adjacent roadways, Landowner agrees to construct, or finance construction of streetlights within the Property, as directed by the Electric Utility Director. Except as may otherwise be permitted by the Electric Utility Director, no street shall be opened to the public unless and until streetlights have been installed in accordance with the Specific Plan and applicable requirements of the Electric Department.

3.4.4 Electrical Efficiency. In order to balance conservation efforts with energy supplies, residential air conditioning units shall have a Seasonal Energy Efficiency Ratio (SEER) of 2 points above minimum as defined in Federal Regulations (10 Code of Federal Regulations Section 430.2 (1991)) adopted by the State of California in Title 24 of the Code of California Regulations. The SEER rating will be specified on building plans and Title 24 compliance certificates at the time building permits are requested. As of the date of this Agreement, the applicable standards would require an increase of SEER Rating from 10 to 12. This increase may be utilized in the overall energy compliance calculations required for the issuance of a building permit for a residential unit.

3.5 Drainage Improvements. Landowner shall provide drainage improvements as provided in this section.

3.5.1 Master Drainage Plan. Prior to approval of any improvement plans for subdivision improvements for Landowner's Property, Landowner shall prepare a Master Drainage Impact Study for its on-site drainage facilities to the satisfaction of the City Engineer. The Master Drainage Impact Study shall identify the size, location and timing of all major drainage facilities proposed for the Property relative to drainage impacts and shall be accompanied by all supporting technical information and calculations.

3.5.2 Other Agency Approval. Prior to the approval of the Master Drainage Impact Study or issuance of any building permit or grading permit, Landowner shall obtain, at

0202 0000 0007 0046 19

its expense, all permits and agreements as required by other agencies having jurisdiction over drainage, water quality or wetlands issues including, but not limited to, the Regional Water Quality Control Board ("RWQCB"), the U.S. Army Corps of Engineers and the California Department of Fish and Game.

Landowner shall prepare and implement a Storm Water Pollution and Prevention Plan (SWP3), and shall construct and maintain Best Management Practices (BMPs) as required by law, the SWP3 and as approved by the RWQCB, concurrently with construction of any improvements. Landowner shall obtain a permit from the RWQCB for the General Construction Storm Water Permit Compliance Program, as required by law, prior to the start of any construction, including grading.

3.5.3 Storm Drains. Landowner shall construct storm drain mains and laterals in accordance with said Master Drainage Plan and with the City's then current improvement standards and shall provide laterals to serve all parcels on the Property, including, but not limited to, commercial, multi-family, church, fire station, and park sites. Storm drain laterals shall be constructed to the property line concurrently with the construction of connecting open channels or storm drain mains. Landowner may use "cast in place" pipe for storm drains which are 24" in diameter or larger.

3.5.4 Grant of Floodplain. Landowner shall, prior to approval of the final large lot subdivision map for the Property, grant to City, in fee, all areas of the Property within the 100-year floodplain, as determined by the City Engineer.

3.5.5 Drainage Easements. Where drainage improvements to be owned and maintained by City are to be constructed by Landowner and are not located within road rights-of-way, as and when Landowner installs such drainage improvements, Landowner shall grant and City shall accept a non-exclusive public utility easement for the ownership and maintenance of such lines, together with access thereto for maintenance purposes only. Easement widths shall be granted in accordance with the City's then current Improvement Standards.

3.6 Water System Improvements. Landowner shall provide improvements to the potable water system as provided in this section.

3.6.1 Water Study. Prior to approval of any improvement plans for any improvements for Landowner's Property, Landowner shall prepare a Water Study for its on-site water facilities, to the satisfaction of the Environmental Utilities Director. The general design of the water system is shown on **Exhibit "F"** hereto, provided the Water Study shall identify the size and locations of the water lines, pressure reducing stations and flow monitoring stations, as well as the timing of such improvements, required to serve the Property relative to water demands and shall be accompanied by all supporting technical information and calculations.

3.6.2 Financing of Water Supply. Landowner shall have no obligation to install or pay for the installation of any off-site water storage, treatment or transmission facilities, except through the payment of water connection fees levied and collected by the City at the time

0202 0000 0007 00470

of development pursuant to then existing City ordinances. Provided, however, City shall not be precluded hereby from imposing on future development within the Property a pro-rata "fair share" special benefit area water connection fee which is specifically developed and adopted to pay for improvements associated with the oversizing of the water transmission system that serve development of the Property.

3.6.3 On-site Water Lines. Landowner shall provide on-site improvements to the water system as shown on Exhibit "F." All improvements to be constructed by Landowner, including mains, shall be designed and constructed pursuant to the City's then current Improvement Standards. Said improvements shall be subject to City plan review, construction inspection and final approval. Landowner shall pay current plan check and inspection costs as is incurred by City for review and inspection of such improvements.

3.6.4 Water System Sequencing. Water system improvements will be constructed incrementally. For purposes of identifying such increments, the improvements to be installed south of Pleasant Grove Creek shall be referred to as the "Southern Improvements" and the improvements to be installed north of Pleasant Grove Creek, including the bridge and related utilities across Pleasant Grove Creek, shall be referred to as the "Northern Improvements." In general, and subject to the Water Study, the 12" water lines shown on Exhibit "F" as part of the Southern Improvements will be installed concurrent with the installation of the corresponding portion of Collector N under which the line is located and the 12" water lines shown on Exhibit "F" as part of the Northern Improvements will be installed concurrent with the installation of the remainder of Collector N and the portion of the road along the northern boundary of the Property under which the line is located. As part of the Southern Improvements, Landowner may provide an additional water line from Blue Oaks Boulevard to loop the water system as shown on Exhibit "F," in lieu of completing the 12" water line through the balance of the Property that is identified as part of the Northern Improvements, or Landowner may install such alternative looped waterline improvements as may be approved by the Environmental Utilities Director.

Extensions into the neighborhoods will be completed with development of each neighborhood. Water lines shall be sequenced to assure looped systems in all developing areas, except as otherwise approved by the Environmental Utilities Director.

3.6.5 Public Utility Easements. Where the water improvements to be constructed by Landowner are not located within road rights-of-way, as and when Landowner installs such water improvements, Landowner shall grant and City shall accept a non-exclusive public utility easement for the ownership and maintenance of such lines, together with access thereto for maintenance purposes only. Easement widths shall be granted in accordance with the City's then current Improvement Standards.

3.6.6 Water Softeners. No water softeners shall be used within the Property except for those approved by the Environmental Utilities Director. Property CC&Rs, if recorded, shall include this prohibition.

0202 0000 0007 00421

3.7 Recycled Water. Landowner shall provide improvements to the City's recycled water system as provided in this section.

3.7.1 Recycled Water Improvements. The City intends to use recycled water for irrigation of parks within the Property, as generally shown on Exhibit "G". Landowner shall construct and dedicate upon completion thereof, a recycled water line extension from the City's backbone system as generally shown on Exhibit "G." Such line shall be sized to serve the park site (W-50 and W-51) with a stub into such parcels as determined by Environmental Utilities. The recycled water line shall be designed so that, until the new trunk sewer to be located through Pleasant Grove Creek is operational, such recycled water line will be used as a temporary wastewater force main to convey wastewater to the force main in Blue Oaks Boulevard built by Phase I of the North Roseville Specific Plan, as described in Section 3.8.1 below. At such time as said trunk sewer is operational, City shall rehabilitate and convert said temporary wastewater force main to a recycled water line.

Landowner shall include in its Neighborhood Park Fee the cost of designing and installing a booster pump station for each park site that will generally consist of a wet well to boost either recycled water or potable water. Potable water will be supplied to parks in addition to the recycled water line. Until such time as recycled water is available, the booster pump station will pump potable water. When recycled water is supplied to the recycled water line, the booster pump station will pump recycled water with the potable supply as the backup. Landowner shall not be charged any connection or hook-up fee when such improvements are connected and brought on-line for service to such park site, whether with potable or recycled water. Landowner shall pay to the City the actual costs (not to exceed \$7,500) incurred by the City to prepare a recycled water engineering report for submission to appropriate state agencies and to obtain any necessary permits relating to the use of recycled water for the park site.

3.7.2 Improvement Standards. All recycled water system improvements shall be designed and constructed pursuant to City's then current Improvement Standards and shall be subject to City plan review, construction, inspection and final approval. This shall apply to transmission, distribution and irrigation systems. Landowner shall pay then current plan check and inspection costs as incurred by City for review and inspection of such improvements. Landowner shall provide booster pumps on the transmission system if determined by the Environmental Utilities Director to be necessary to serve the Property.

3.7.3 Public Utility Easements. Where the recycled water improvements are not located within road rights-of-way, as and when such recycled water improvements are installed, Landowner shall grant and City shall accept a non-exclusive public utility easement for the ownership and maintenance of such lines, together with access thereto for maintenance purposes only. Easement widths shall be granted in accordance with the City's then current improvement standards.

3.8 Sewer Improvements. Landowner shall provide on-site improvements to the sewer system as described in this Section.

0202 0000 0007 0012

3.8.1 Master Wastewater Plan. Prior to approval of any improvement plans for any improvements for Landowner's Property, Landowner shall prepare a Wastewater Study for its on-site wastewater facilities, as shown on Exhibit "H" hereto, including the interim pump station and force main described below, all to the satisfaction of the Environmental Utilities Director. All sewer improvements shall be consistent with the Regional Wastewater Master Plan. The area will be served by the Roseville Regional Wastewater Treatment Plant on Dry Creek at the end of Booth Road until the new treatment plant is constructed by the City on Pleasant Grove Creek. The wastewater system is designed to ultimately convey wastewater from Neighborhood C through a new Pleasant Grove Creek trunk sewer along the Pleasant Grove Creek alignment.

In the short term, initial phase, a new pump station will be located near the west edge of Neighborhood C along Pleasant Grove Creek adjacent to the new Pleasant Grove Creek trunk sewer. The sewage will be pumped to the force main (future 8" recycled waterline) in Blue Oaks Boulevard built by Phase 1 of North Roseville Specific Plan. Sewage from the 8" force main in Blue Oaks Boulevard will be directed south to the existing gravity sewer system in Mourier 140, where it will discharge to the 8" sewer in Collector "F" and flow to the 12" sewer in Collector "G," then to the 42" sewer in Woodcreek Oaks Boulevard. The addition of the wastewater flow from Neighborhood C to the Mourier 140 system will require a temporary variance in the City's sewage discharge policy in that at full buildout of both Mourier 160 and Mourier 140, the 8" sewer in Collector "F" will flow at a rate above the allowable seventy percent (70%) of capacity and the 12" sewer in Collector "G" may surcharge at peak flow conditions. To minimize the occurrence of these conditions, the pump station will be constructed to operate at two (2) stages. Stage 1 will operate at the average daily flow rate. Stage 2 will operate at the flow rate necessary to obtain a velocity in the 8" force main of at least three and one-half (3.5) feet per second in order to re-suspend solids. The second stage will operate once per day during off-peak operating hours. The second stage will also provide additional pumping capacity as may be necessary during peak flow conditions. This entire on-site and off-site system is shown on Exhibit "H-1" hereto.

When the Pleasant Grove Creek plant begins operation, the wastewater from Neighborhood C would no longer be pumped from the new pump station located in Neighborhood C, but would gravityflow on to the new plant downstream to the west through the new Pleasant Grove Creek trunk sewer.

The Wastewater Study shall identify the size of the wastewater lines, pump station and related facilities, as well as the timing of such improvements, required to serve the Property relative to wastewater demands and shall be accompanied by all supporting technical information and calculations.

Except for the improvements expressly described in the approved Wastewater Study, Landowner shall have no obligation to install or pay for the installation of any off-site treatment or transmission facilities, except through the payment of sewer connection fees levied and collected by City at the time of development pursuant to then existing City ordinances.

0202 0000 0007 0050 23

3.8.2 Improvement Standards. All sanitary sewer improvements shall be designed and constructed pursuant to City's then current Improvement Standards and shall be subject to City plan review, construction inspection and final approval. Landowner shall pay then current plan check and inspection costs as incurred by City for review and inspection of such improvements. All sewer system improvements shall minimize the generation of hydrogen sulfide, and include protection from hydrogen sulfide corrosion.

3.8.3 Access to Manholes. All manholes shall be located so that they are accessible by City sewer maintenance vehicles, unless otherwise approved by the Environmental Utilities Director.

3.8.4 Public Utility Easements. Landowner shall be solely responsible for obtaining all easements and rights-of-way located outside of the Property that are required for the construction of the improvements identified by the Wastewater Study. City shall provide Landowner with any rights-of-entry needed to connect these improvements to the City's existing lines. Where the wastewater improvements to be constructed by Landowner are not located within road rights-of-way, as and when Landowner installs such wastewater improvements, Landowner shall grant and City shall accept a non-exclusive public utility easement for the ownership and maintenance of such lines, together with access thereto for maintenance purposes only. Easement widths shall be granted in accordance with the City's then current Improvement Standards.

Upon request of City, if Landowner has not then granted to City in fee the Pleasant Grove open space pursuant to Section 3.2.1 above, Landowner shall grant to City, at no cost to City, a temporary construction easement and a permanent operation and maintenance easement as needed for the City's construction of the new Pleasant Grove Creek trunk sewer. The terms and conditions of such easements shall be mutually acceptable to both parties, provided City shall cooperate with Landowner to minimize the impact of its construction and maintenance under such easements on Landowner's adjacent development of the Property.

3.8.5 Sequencing of Wastewater Improvements. Wastewater improvements shall be installed in the sizes and timing as provided in the approved Wastewater Study. In general, and subject to the requirements of the Wastewater Study, the wastewater improvements identified as part of the Southern Improvements shall be installed prior to the issuance of a building permit for any building, excluding permits for model homes, within Parcels W-4 or W-5 and the wastewater improvements identified as part of the Northern Improvements shall be installed prior to the issuance of a building permit for any building, excluding permits for model homes, within Parcels W-1, W-2 or W-3. In any event, wastewater lines to be located within particular roadways shall be installed concurrent with the installation of the corresponding road improvements, if not installed prior thereto.

3.9 Road Improvements. Landowner, at its expense, shall provide the following road improvements in the manner and at the time as provided in this section.

0202 0000 0007 0004

3.9.1 Landowner Obligations. Landowner's obligation for roadway improvements shall consist of the construction of curb, gutter, sidewalk, utilities, streetlights and the first eighteen feet (18') of pavement therefrom (including, but not limited to, asphalt, concrete, aggregate base and aggregate sub-base) for the portion of the road rights-of-way adjacent to the Property, and any additional pavement widening at intersections to accommodate turn lanes and bus turnouts, all grading, drainage laterals and inlets, cross culverts and bridges, except the portions thereof that are interior to the street and extend beyond eighteen feet (18=) from the edge of the pavement, traffic signing and striping , underground portions of traffic signals and signal interconnects in conjunction with joint trench work along all arterial roadways and at other locations deemed necessary by the City Engineer (collectively, "frontage improvements"). The area within which such frontage improvements are to be located shall be referred to herein as "Landowner's frontage."

Where there are streets adjacent to open space, Landowner shall be responsible for full street improvements. Such improvements shall include sidewalks and landscaping adjacent to open space where required by the Design Guidelines for the Property.

As to any road improvements to be constructed by Landowner hereunder, Landowner shall have the responsibility of securing all state and federal permits necessary for such construction.

3.9.2 Blue Oaks. Landowner shall dedicate all necessary right-of-way and shall construct the frontage improvements and necessary transitions for that portion of Blue Oaks Boulevard which abuts the southerly boundary of the Property.

3.9.3 Fiddymment Road.

3.9.3.1 The City is negotiating with and desires to reach agreement with the County of Placer to realign the right of way for Fiddymment Road away from the Property, as generally shown on Exhibit "I-1." In the absence of such realignment, Landowner would be responsible for installing certain road improvements, including pavement, landscaping, sidewalk, streetlights, utilities and ancillary improvements adjacent to and along the western boundary of the Property within the current alignment of Fiddymment Road. For purposes hereof, City and Landowner agree that the cost for the design and construction of such Landowner improvements to Fiddymment Road, together with the demolition and removal costs described below, shall be deemed to be Three Hundred Three Thousand Four Hundred Three Dollars (\$303,403).

In lieu of constructing such frontage improvements, Landowner agrees that the City may, at its sole option, require Landowner to either (i) design and construct the improvements to Fiddymment Road, either in its current alignment or as may subsequently be agreed to be realigned with the County, from the northwest corner of the Property to the westernmost ninety-degree curve before the Pleasant Grove Creek crossing, as shown on Exhibit "I-1", subject to the City and/or third party obtaining all necessary rights-of-way therefor and paying all costs thereof in excess of said \$303,403, or (ii) contribute said \$303,403

0202 0000 0007 00525

to the City for the City to design and install the improvements to Fiddymment Road, either in its current alignment or as may subsequently be agreed to be realigned with the County. In either event, such amount shall be included in the CFD to finance Landowner's share for Fiddymment Road and Landowner shall have no obligation to construct the frontage improvements to Fiddymment Road within the current alignment therefor.

The City shall decide between the foregoing alternatives at such time that a residential lot tentative map is submitted for either Parcel WW-1 or Parcel WW-2 or at such time that plans are submitted to the City for the Northern Improvements to be constructed by Landowner. Provided, however, City may not require Landowner to design and construct the realigned Fiddymment Road improvements unless, at the time of such election, (i) the City has then reached a written, binding agreement with the County to proceed with such proposed realignment and (ii) the City and/or County have obtained all necessary rights-of-way for such construction or are proceeding with efforts to obtain such right-of-way and reasonably expect to obtain such right-of-way prior to Landowner's commencement of construction of its Northern Improvements. If City does not notify Landowner of its election within such time, then City shall be deemed to have elected that Landowner contribute the funds to City for City to design and construct such improvements.

If City timely notifies Landowner to construct the realigned Fiddymment Road, Landowner shall commence the design and permitting for Fiddymment Road, in accordance with the proposed realignment agreed to by the City and County therefor, at the same time as Landowner commences its design for its Northern Improvements. Landowner shall commence construction of the improvements to Fiddymment Road in the new alignment therefor upon the later of (i) completion of such design acceptable to both the City and the County and obtaining of any necessary permits and approvals and rights-of-way therefor or (ii) Landowner's commencement of construction of its Northern Improvements. Landowner shall not be required hereby to defer or delay the construction of any of its on-site improvements or development of the Property pending any approval for or construction of realigned Fiddymment Road, so long as Landowner is using good faith efforts to process and complete the design, permitting and construction thereof. The City agrees to use its best efforts to expedite the review and approvals of such design and shall cooperate with and support Landowner's efforts to obtain any necessary permits and rights-of-way in order that Landowner may commence construction of the Fiddymment Road improvements at the same time as it commences construction of its Northern Improvements.

City shall promptly pay Landowner for its share of the construction costs thereof in accordance with Landowner's construction contract therefor, which shall be bid and entered into in consultation with City in accordance with bidding and contracting procedures for CFD improvements. In addition to such construction cost, City agrees that it will promptly pay its share for the costs of design, engineering and construction staking, inspection, geotechnical and soils testing, tree service and costs related thereto, any required permits for the improvements (including any required 404 Permits and/or Section 1603 streambed alteration agreements and consultant costs and mitigation related thereto), the costs to demolish, remove and dispose of the existing improvements to Fiddymment Road (at least along the western

0202 0000 0007 0053

boundary of the Property), and similar items related to such construction and demolition. City will also pay Landowner its share for management of the construction and demolition of such improvements equal to four percent (4%) of construction costs, which shall cover costs of project management, permit coordination and construction management, and which payment shall be made at the same time as City pays such construction costs. The City's share of such costs shall be based on the total costs for the improvements, less the \$303,403 to be funded by Landowner hereunder for such improvements.

City shall promptly pay its share as and when the contractor or applicable consultant presents invoices to Landowner for work which has been approved by City Inspectors. Landowner shall bill City for such invoiced work and any other costs incurred by Landowner for or related to this work to be paid by City hereunder, and City shall promptly pay Landowner its share of the amounts set forth therein within fifteen (15) days after deliver of such bill to City, in order to avoid any delay or claims of lien against the Property. The City's agreement to pay the pro rata share of such costs in excess of the amount to be contributed therefor by Landowner shall not preclude City from recovering any of such costs from the County or other benefitting landowners. Upon completion of the work and payment of all costs therefor, Landowner shall prepare a final accounting and the parties shall make any appropriate adjustments between their respective payments so that Landowner will have paid its \$303,403 therefor and the City shall have paid the balance thereof.

If the City elects (or is deemed to have elected) that Landowner contribute the funds for Fiddymment Road as described above, such contribution shall be due and payable upon the issuance of the first building permit within either Parcel W-1, W-2 or W-3, but in any event, not later than August 15, 2002. The payment of such contribution shall be secured by inclusion of such funding in the CFD for the Project. City shall use such funds solely for improvements to Fiddymment Road, in either the current alignment or as may be realigned through agreement with the County.

In either case, the fencing/wall/landscaping treatment to be located adjacent to the existing Fiddymment Road right-of-way along the western boundary of the Property shall be designed and constructed by Landowner in accordance with the Specific Plan and Design Guidelines.

3.9.3.2 Landowner shall not be entitled to any credit or reimbursement from City for any of the foregoing improvements to Fiddymment Road funded by Landowner's \$303,403 therefor, provided the CFD may reimburse Landowner for any advance thereof by Landowner. In consideration of Landowner's waiver of any such right to reimbursement, City acknowledges and agrees that Landowner shall not have any responsibility for the cost of any landscaped median in Fiddymment Road and that no CFD funds shall be reserved or used to pay for any such landscaped median.

3.9.4 Collector Streets. To provide access to the Property, Landowner shall construct curb, gutter, pavement, streetlights, utilities, entry medians and ancillary improvements related thereto as shown in the Entitlements for those roadways identified in **Exhibit I** attached

0202 0000 0007 0054  
27

hereto (the "Collector Streets") located within the Property. Landowner shall not be entitled to any credit or reimbursement from City for constructing such improvements, provided the CFD may acquire such improvements. Landowner may elect, upon approval of the City, but shall not be obligated, to construct the street along the northern boundary of the Property from the intersection of Collectors N and O to the eastern boundary of the Property as a Collector Street, consistent with the requirements for Collector O. Any such election by Landowner to extend Collector O along the northern boundary of the Property shall be made no later than the time that Landowner submits a residential lot subdivision map for Parcel W-3.

Landowner shall complete construction of the portion of Collector N from Blue Oaks Boulevard to the southern boundary of Pleasant Grove Creek as part of the Southern Improvements prior to the issuance of the first building permit within the Property, excluding permits for model homes. Landowner shall complete construction of the balance of Collector N (including the crossing of Pleasant Grove Creek) and Collector O as part of the Northern Improvements prior to the issuance of the first building permit, excluding permits for model homes, within Parcel W-1, W-2 or W-3.

### 3.9.5 Timing of Road Improvements.

3.9.5.1 Except for the timing of Fiddymont Road as described in Section 3.9.3 and the Collectors as described in Section 3.9.4, Landowner shall construct the road improvements described in this Section 3.9 at the time described in Section 3.15 hereof.

3.9.5.2 Upon recordation of either the Large Lot Map for the Property or a residential-lot subdivision map for any portion of the Property, whichever occurs first, Landowner shall dedicate the rights-of-way within the Property required for the improvements described in this Section 3.9, as such right-of-way is shown in the Specific Plan.

3.9.5.3 Sidewalks and landscaping to be installed within the road rights-of-way within the Property shall be installed concurrently with the subdivision improvements for any adjacent single-family residential-lot subdivision. Sidewalks adjacent to open space parcels shall be installed concurrently with corresponding road improvements.

3.9.6 Road Improvement Standards. All improvements to be installed by Landowner shall comply with the City's then current standards for public streets. The rights-of-way required for such road improvements shall be as set forth in the Specific Plan, or, if not shown in the Specific Plan, then as set forth in the City's Improvement Standards.

3.9.7 Landscape Setbacks. For the roadways within and/or adjacent to the Property, Landowner shall establish the applicable landscape setbacks provided therefor by the Specific Plan and/or Design Guidelines. Such setbacks shall be measured generally from back of curb, except along intersections where bus turnouts, turn lanes, and other similar facilities may encroach into the landscape setback to the extent permitted by the North Roseville Specific Plan Design Guidelines. Such landscape setbacks shall be limited to landscaping, streetlights,

0202 0000 0007 0055  
28

utilities, sidewalks, soundwalls and related uses, and shall be included in the right-of-way, as set forth in the Specific Plan.

3.9.8 Traffic Signals. Landowner shall have no obligation to install or pay for the installation of any traffic signals within or adjacent to the Property, except through payment of the Traffic Mitigation Fee levied and collected by the City at the time of development pursuant to then existing City ordinances. Notwithstanding the foregoing, Landowner shall install or pay for any portion of a traffic signal installed to service a private drive into an adjacent parcel and Landowner shall install conduit and sleeves as part of the road improvements at applicable intersections for subsequent installation of traffic signals, as required by City.

3.9.9 Cirby-Riverside. Landowner agrees to fund its share of the Phase II advance of \$300,000 for improvements to the Cirby-Riverside interchange (the "Cirby-Riverside Advance"). Landowner's share of such advance shall be \$55,111. Landowner's share of the Cirby-Riverside Advance shall be due upon the first sale of CFD bonds secured by the Property, but in no event later than December 31, 1999, and shall be included for financing by the CFD. If Landowner is obligated to fund its share of such Advance in cash prior to the issuance of the first bond sale for the Property, then Landowner shall have the right to be reimbursed from the CFD for such cash advance upon the later CFD bond sale.

3.9.10 Update of City Fee Programs. City will amend its current Traffic Mitigation Fee (Roseville Municipal Code Chapter 4.44) Ordinance (the "Fee Ordinance") so as to apply to and include all the Property. The cost for this update shall be borne by Landowner. City shall use its best efforts to complete this fee update within one (1) year of the effective date of this Agreement. The City currently estimates that the amended fee will be approximately the same as those charged in the North Industrial Roseville Plan Area ("North Industrial"). Upon amendment, Landowner agrees to pay such fee at the time of building permit issuance. Furthermore, Landowner agrees that until such time as City amends the Fee Ordinance to include the Property, the provisions thereof (as the same exist or may hereafter be amended) applicable to North Industrial shall apply to the Property and Landowner shall pay such fee (hereinafter the "Interim Fee") in the amount and at the time specified in the Fee Ordinance. If Landowner pays the Interim Fee prior to amendment of the Fee Ordinance, and if the Interim Fee exceeds the fee that would otherwise have been adopted for the Property, then the excess amount collected from payment of such Interim Fee shall be applied to reduce the fee to be adopted for the balance of the Property. If the Interim Fee is less than the fee that is ultimately adopted for the Property, then the total amount of the shortfall shall be added as a surcharge to such fee on a per-unit basis.

Landowner agrees that the Property will be included in the assessment district formed pursuant to the Bizz Johnson Highway Interchange Joint Powers Authority (the "JPA") for the purposes of constructing interchanges along Highway 65 at Harding Boulevard/Stanford Ranch Road, Pleasant Grove Boulevard, Blue Oaks Boulevard and Sunset Boulevard. Landowner waives herewith any objection and consents to and will cooperate with City in the inclusion of the Property within such district.

0202 0000 0007 0056

Landowner shall bear those costs of updating the JPA Fee program to include the Property. It is estimated that the updated fee will be approximately the same as that charged in the Northwest Roseville Specific Plan Area ("Northwest Roseville"). Upon amendment, Landowner agrees to pay such fee at the time specified therefor. Furthermore, Landowner agrees that until such time as the JPA Fee program is amended to include the Property, the provisions thereof (as the same exist or may hereafter be amended) applicable to Northwest Roseville shall apply to the Property and Landowner shall pay such fees (hereinafter the "Interim JPA Fee") in the amounts and at the times specified in the JPA Fee program. If Landowner pays the Interim JPA Fee prior to amendment of the JPA Fee program, and if the Interim JPA Fee exceeds the fee that is ultimately adopted for the Property, then the excess amount collected from payment of such Interim JPA Fee shall be applied to reduce the JPA Fee to be adopted for the balance of the Property. If the interim JPA Fee is less than the JPA Fee that is ultimately adopted for the Property, then the total amount of the shortfall shall be added as a surcharge to such fee on a per-unit basis.

Nothing in this Section shall be construed as an agreement to an allocation of assessment or benefit to a particular parcel or parcels or to constitute a waiver of the right of Landowner to protest an allocation of a particular assessment burden or benefit associated with the updates of the foregoing fee programs.

3.9.11 Light Rail Funding. Landowner consents to and agrees that the Property shall participate in its fair share of a city-wide funding mechanism for the extension and operation costs of light rail into the City of Roseville.

3.9.12 Master Plan Funding. Landowner consents to and agrees that the Property shall participate in its fair share of city-wide funding mechanisms for the updates of the City's Bikeway Master Plan and Long Range Transit Master Plan.

3.9.13 Transportation Systems Management. Landowner and its successors shall comply with the City's Transportation Systems Management Ordinance.

### 3.10 Miscellaneous Public Facilities and Services.

3.10.1 Fire Tax. During the term of this Agreement, Landowner or its successors shall continue to pay the Fire Service Construction Tax set forth at Chapter 4.46 of the Roseville Municipal Code.

3.10.2 County-Wide Facilities Fee. Landowner and City intend that Landowner will pay the pending County-wide Facilities Impact Fee, in accordance with the provisions of Sections 2.4.1 and 2.5.2 above, if and when adopted by the City.

3.10.3 Cultural Resource Area. Landowner acknowledges that an area within the developable portion of the Property has been identified by the Subsequent EIR as a potential cultural resource. Prior to the recordation of a large lot subdivision map for the Property, Landowner shall perform or cause to be performed further archeological investigation of such

0202 0000 0007 0050

potential resource to determine the value of such resource and any necessary preservation or mitigation that may be recommended in connection with development of such area. Such further investigation, including any recommendations thereof for preservation and/or mitigation of such potential cultural resource, shall be performed in accordance with the standards typical for such industry. If such study recommends the preservation of any developable portion of the Property, the parties shall revise the boundaries of the developable portion of the Property consistent with the recommendations of such study prior to the recordation of the large-lot subdivision map for the Property; if the study does not recommend the preservation of any area, then Landowner may proceed with the large-lot subdivision of the Property, consistent with the terms of this Agreement and any mitigation recommended by the study.

3.11 Liens, Encumbrances, Covenants, Conditions and Restrictions. Except as approved by the City or provided for by this Agreement, all property to be conveyed in fee to the City pursuant to this Agreement shall be free of any liens, financial encumbrances, special taxes, hazardous materials or assessments, provided the City's interest shall be subject to the application of the Project CC&Rs to the extent the conditions, covenants and restrictions thereof implement the provisions of the Specific Plan or this Agreement with respect to such interest. In addition, Parcels W-50 and W-51 (as shown on Exhibit "B") to be conveyed hereunder to the City shall be free of wetlands. Landowner shall, for each such conveyance, provide to City at Landowner's expense a current preliminary title report and preliminary site assessment for hazardous waste in a form approved by the City Attorney. Any policy of title insurance required by City shall be at City's expense. Prior to any such conveyance by Landowner, Landowner shall be responsible at its sole cost and expense to fill any wetlands located on the applicable Parcels to be conveyed in accordance with the terms and conditions of the 404 Permit, to be adopted pursuant to Section 2.7 above.

3.12 EIR Mitigation Measures. Notwithstanding any other provision in this Agreement to the contrary, as and when Landowner elects to develop the Property, Landowner shall be bound by, and shall perform, all mitigation measures contained in the Plan EIR and Subsequent EIR related to such development which are adopted by the City and are identified in the mitigation monitoring plan or the Plan EIR and/or Subsequent EIR as being a responsibility of Landowner.

3.13 Waiver. In consideration of the benefits received pursuant to this Agreement, Landowner, on behalf of itself and its heirs, successors in interests and assigns, waives any and all causes of action which it might have under the ordinances of the City of Roseville or the laws of the State of California or the United States with regard to any otherwise uncompensated or undercompensated conveyance or dedication of land or easements over the Property or improvements that are specifically provided for in this Agreement. This waiver shall not apply to any conveyances or dedications of land or easements that are not specifically contained in this Agreement and are subsequently desired by the City.

0202 0000 0007 0058

**3.14 Community Facilities District and Financing.**

**3.14.1 Community Facilities District.**

3.14.1.1 City and Landowner agree that if requested by Landowner, City and Landowner will use their best efforts to cause to be formed for the purpose of financing the acquisition or construction of the improvements or facilities described in **Exhibit "J,"** attached hereto (the ACFD Improvements), and Landowner waives any objection to the formation of, a Community Facilities District (herein "CFD") pursuant to the provisions of this Section 3.14 and Section 53311 et seq. of the Government Code. City and Landowner agree that, if formed, the CFD shall include all the property shown on the Specific Plan as Parcels W-1 through W-5, inclusive.

3.14.1.2 City and Landowner agree that, with the consent of Landowner and to the extent permitted by law, City shall use its best efforts to cause bonds to be issued in amounts sufficient to effect the purposes of this section. Landowner shall be allocated Landowner's share of infrastructure costs and shall be assessed special taxes in a fair and proportionate manner in accordance with the financing plan for the Specific Plan.

3.14.1.3 Nothing in this section shall be construed to preclude the payment by an owner of any of the Parcels to be included within the CFD a cash amount equivalent to its proportionate share of costs for the CFD Improvements, or any portion thereof, prior to the issuance of bonds.

3.14.1.4 Concurrent with the formation of the CFD, Landowner and City shall enter into a shortfall agreement, in form and substance acceptable to City, whereby Landowner shall covenant to finance its fair share of the costs of the CFD Improvements, to the extent that the bonds issued by the CFD do not provide sufficient funding for the completion of such Improvements.

3.14.1.5 Nothing herein shall be construed to limit Landowner's option to install the CFD Improvements through the use of private financing.

3.14.2 Effect of CFD Financing on Credits and Reimbursements. Wherever the terms of this Agreement provide for (a) credits or (b) reimbursements to Landowner in consideration of the construction of certain improvements, if and where those improvements are financed by the CFD, then (a) any credits associated therewith shall be allocated to and run with the Parcels within the CFD in such proportions as City and Landowner shall agree in writing, and (b) any reimbursements associated therewith shall be paid to the CFD.

3.15 Completion of Improvements. City generally requires that all improvements necessary to service new development be completed prior to issuance of building permits (except model home permits as may be provided by the City's Subdivision Ordinance). However, the parties hereto acknowledge that all of the CFD Improvements associated with the development

0202 0000 0007 0059

of the Property may not need to be completed to adequately service portions of the Property as such development occurs. Therefore, as and when portions of the Property are developed, all CFD Improvements required to service such portion of the Property in accordance with the Entitlements (e.g., pursuant to specific tentative map conditions or other land use approvals) shall be completed prior to issuance of any building permits within such portion of the Property (except permits for model homes, which may be issued sooner in accordance with the City's subdivision ordinance). Provided, however, the City Engineer may approve the issuance of building permits prior to completion of all of such CFD Improvements if the improvements necessary to provide adequate service to the portion of the Property being developed are substantially complete to the satisfaction of the City Engineer.

Landowner further acknowledges that all utilities to be installed by Landowner pursuant to Sections 3.5, 3.6, 3.7 and 3.8 will be subject to the review and approval of the City Environmental Utilities Department. In connection therewith, Landowner shall be responsible for coordinating the alignment of all such planned and future utilities within the applicable rights-of-way to the satisfaction of the City Environmental Utilities Department.

### 3.16 Services District.

#### 3.16.1 Formation.

3.16.1.1 Consent, Waiver and Special Benefit. No residential building permit, excluding permits for model homes, shall be issued until the Property has been annexed into the North Roseville CFD Services District. Landowner consents to and shall cooperate in such annexation or formation or other such financing mechanism for maintenance purposes (herein the "Services District"), and consents herewith to the levy of such special taxes as are necessary to fund the maintenance obligations described in Section 3.16.2 below. For purposes of Article XIID of the California Constitution, Landowner acknowledges hereby that all the services described herein to be provided by the Services District will provide a "special benefit" to the Property as defined by said Article and that the foregoing support and consent shall apply as to any claim that any portion of the services supported by the special tax does not provide special benefit to the Property.

3.16.1.2 Public Parcel Exclusion. Landowner expressly agrees that Parcels conveyed or to be conveyed to the City of Roseville shall be excluded from any assessment to be imposed by the Services District.

3.16.2 Obligations. The Services District, as described in Section 3.16.1, shall:

3.16.2.1 provide a mechanism for the perpetual maintenance of (i) one-half of the median and the scenic corridor contiguous to those portions of Blue Oaks Boulevard within and adjacent to the Property and (ii) scenic corridor, if any, contiguous to those portions of Fiddymont Road within and adjacent to the Property;

3.16.2.2 perform autumn leaf cleanup for collector and local streets;

0202 0000 0007 0060

3.16.2.3 maintain all public pedestrian or bicycle pathways which connect single-family residential parcels to roadways, schools and park sites, to the extent that such pathways are not within or adjacent to public streets or within improved park sites or otherwise required to be maintained by City hereunder;

3.16.2.4 maintain all public open space areas within the Property, other than improved park sites, as such maintenance is more particularly described in the adopted Design Guidelines for the Property;

3.16.2.5 maintain all the Environmental Preserves, including any buffer areas related thereto, in accordance with the Specific Plan, provided however, the costs arising out of or associated with compliance with Landowner's 404 Permit shall be assessed exclusively upon the Property and not upon any other landowner's property within the District. In lieu of the Services District maintenance of the Wetland Compensation Areas, if requested by Landowner, City agrees that an endowment fund will be created in order to fund the perpetual maintenance, monitoring and reporting requirements for the Wetland Compensation Areas. If Landowner requests the City to create such a fund, Landowner shall consent to City's imposition and collection of an "environmental endowment fee" to be assessed exclusively upon the Property in an amount per residential lot to be agreed upon with the City, payable at the time an application for a building permit is filed with the City. City shall deposit all such fees so collected into a specially designated account in order to fund an endowment for the perpetual maintenance, monitoring and reporting costs of the Wetland Compensation Areas. The endowment may only be used for the cost of maintenance, monitoring and reporting for the Wetland Compensation Areas as required by the 404 Permit and all amendments thereto. Prior to the time when the environmental endowment fees have been collected from all residential lots within the Property, the Services District will assume the costs of monitoring, reporting and maintaining the Wetland Compensation Areas in accordance with the requirements of the 404 Permit and all amendments thereto;

3.16.2.6 maintain City and neighborhood entry features to the Property and ancillary landscaping;

3.16.2.7 conduct, manage and finance the environmental mitigation monitoring, and the annual review thereof, as required by the mitigation monitoring plan related to the Plan EIR; and

3.16.2.8 maintain the street trees in the Landscape setbacks described in Section 3.9.5.A.

3.16.3 Encroachment Permits, Landscape Maintenance Easements. Landowner and City agree to grant encroachment permit(s) or maintenance easements to the Services District, Landowner or City or their agents, employees, successors, assigns, agents and employees, for the purpose of entry into the landscape easement and setback areas or City

0202 0000 0007 0061

property (including streets and rights-of-way) to perform the maintenance obligations described herein.

#### **SECTION 4: CITY OBLIGATIONS**

4.1 City Cooperation. The City agrees to cooperate with Landowner in securing all permits which may be required by City. In the event State or Federal laws or regulations enacted after this Agreement has been executed, or action of any governmental jurisdiction, prevent, delay or preclude compliance with one or more provisions of this Agreement, or require changes in plans, maps or permits approved by City, the parties agree that the provisions of this Agreement shall be modified, extended or suspended as may be necessary to comply with such State and Federal laws or regulations or the regulations of other governmental jurisdictions. Each party agrees to extend to the other its prompt and reasonable cooperation in so modifying this Agreement or approved plans.

4.2 Credits and Reimbursements. Landowner may, pursuant to this Agreement, be financing construction of certain improvements which would otherwise be paid for by the City or other parties and which serve other properties or which would be financed by existing City fees. City and Landowner agree that, in consideration of the financing of such improvements by Landowner, and only where this Agreement explicitly so provides, Landowner shall be entitled to credits and reimbursement as follows:

4.2.1 Credits Against Fees. Landowner shall receive the following fee credits:

4.2.1.1 Citywide Park Fee. In consideration of Landowner's covenant to fund its share of the Community Center Advance pursuant to Section 3.2.2, Landowner shall receive credits against the Citywide Park Fee equal to Landowner's share of such Advance. Such fee credits shall be spread to the units within the Plan Area as agreed to by Landowner and City, and may be assigned by Landowner, provided, Landowner shall give written notice to City of any such assignment. Landowner shall receive no credits for funding its share of the Little League Advance described in said Section 3.2.2.

4.2.1.2 Traffic Mitigation Fee. In consideration of Landowner's covenant to fund its share of the Cirby-Riverside Advance pursuant to Section 3.9.9 and to include the financing therefor in the CFD, Landowner shall receive credits against the City's Traffic Mitigation Fee equal to Landowner's share of such Advance. Such fee credits shall be spread to the units within Parcels W-4 and W-5 and may be assigned by Landowner, provided, Landowner shall give written notice to City of any such assignment.

4.2.2 Participation/Reimbursement By City. The parties agree that Landowner shall not be entitled to any reimbursement from the City for the construction of any public improvements required by this Agreement unless explicitly provided by the agreement. Provided, however, City and Landowner agree that if City timely elects to have Landowner construct the improvements to Fiddymont Road in its proposed realignment pursuant to Section

0202 0000 0007 0062  
5

3.9.3 above, City shall pay its pro rata share of the costs therefor as provided in Section 3.9.3 hereof.

4.2.3 Reimbursement by Third Parties. In the case of public road improvements which abut property owned by third persons and other public improvements which are oversized to benefit property owned by third persons, Landowner shall be entitled to receive a reimbursement from the benefited property's owner (and not the City) for the pro rata cost of the improvements which exceed Landowner's obligation. Reimbursement may be provided directly from the owner abutting such improvements or from a community facilities district or any such other infrastructure financing district if such a district is formed by or includes such properties and includes monies for the construction of said improvements.

City shall use its best efforts, to the extent City has the authority to do so, to impose the obligation to pay said reimbursement, as a condition of development of such benefited property, at the time such property owner requests a discretionary approval or other such entitlement from City for development of the benefited property whereby such condition can be imposed. Such reimbursement shall be due and payable on the earlier of issuance of a permit for a grading, improvement or construction on the benefited property, recordation of a final parcel or subdivision map for the benefited property or receipt of funds from an infrastructure financing district that is formed by or includes such benefited property. City's obligation to impose such condition and collect such reimbursement shall terminate upon any termination of this Agreement.

4.2.4 Reimbursable Hard Costs. The "hard costs" of construction to be reimbursed to Landowner by the City or a third party or to be paid by Landowner to any third party in accordance with the terms of this Agreement shall consist of the identifiable and commercially reasonable costs of the design, engineering and construction as actually incurred by Landowner or such third party for the reimbursable work.

4.2.5 Interest on Reimbursements. In each case in which this Agreement provides that Landowner is entitled to receive reimbursement for improvements from third parties or is required to pay reimbursement to third parties, Landowner shall be entitled to receive, or be obligated to pay, interest on the amount to be reimbursed (the "base amount") at the time when the reimbursement is to be paid. Such interest shall be the lesser of the following, as calculated by the Finance Director:

4.2.5.1 The difference between the estimated cost to construct the reimbursable improvements at the time of reimbursement (as estimated by the Finance Director) and the base amount; and

4.2.5.2 The amount of adjustment to the base amount for construction costs inflation, based upon the Engineering News Record, Construction Cost Index for the United States, 20-city average (should such index no longer exist, the Finance Director shall choose a similar index which in his/her opinion fairly estimates the inflation factor applicable to construction), from the time of completion and acceptance to the time of reimbursement.

0202 0000 0007 0063

4.2.6 Term for Credits and Reimbursements. City's obligation to provide any credits or to pay any reimbursements to Landowner that accrue hereunder shall terminate twenty (20) years after the effective date of this Agreement.

4.2.7 Not a Limitation. Nothing in the foregoing Section 4.2 shall be construed to limit Landowner from receiving, in consideration of the improvements to be constructed by Landowner hereunder, any other credits or reimbursements from City otherwise provided under then existing City policy, rule, regulation or ordinance.

4.3 Applications for Permits and Entitlements.

4.3.1 Action by City. City agrees that it will accept, in good faith, for processing review and action, all applications for development permits or other entitlements for use of the Property in accordance with the Entitlements and this Agreement, and shall act upon such applications in a timely manner.

4.3.2 Maps and Permits. Provided that the CFD has been formed and is duly authorized to levy the special tax therefor in accordance with Section 3.14 hereof, and further provided that the Services District has been or will at the time of the requested final approval be formed and authorized to levy the special tax against the applicable portion of the Property in accordance with Section 3.16 hereof, and further provided that Landowner is not in default under this Agreement, City shall not refrain from approving final residential lot subdivision maps nor shall it cease to issue building permits, certificates of occupancy or final inspections for development of the Property that is consistent with the Entitlements. The acceptance, review and approval of any application for a final residential lot subdivision map, final non-residential subdivision map or building permit may be conditioned upon the formation of the CFD and the submission of a petition to form the Services District or annex the Property into the Services District, as applicable. Prior to such formation and/or annexation, City shall accept, for review, processing and approval, consistent with the Entitlements, applications for tentative residential lot and non-residential subdivision maps and for tentative and final large-lot subdivision or parcel maps consistent with the Parcels described by the Specific Plan for the Property.

City acknowledges that under Government Code Section 66452.6, the term of a tentative subdivision map will be automatically extended for a period of time where a subdivider is obligated to install certain improvements located outside the boundaries of the subdivision. In determining the term of any tentative subdivision map approved by the City for the Property, or any portion thereof, and without limiting the effect of any other provisions of the Government Code dealing with map extensions, the City agrees that the CFD Improvements described hereunder shall be treated as such off-site improvements for purposes of applying Section 66452.6 of the Government Code.

4.3.3 Personnel. Nothing in this Agreement shall be construed to require City to hire or retain personnel for the purposes of evaluating, processing or reviewing applications for permits, maps or other entitlements or for the design, engineering or construction of public

0202 0000 0007 0064

facilities in excess of those for which provision is made in the normal and customary budgeting process or fee schedules of City.

4.4 Subdivision Map Act Waiver. Notwithstanding any other provision of this Agreement, or of Sections 66452.1, 66452.2, 66456.2 and 66458, of the Government Code (or any successor or replacement statute), Landowner expressly waives the time limits for review and approval by City of tentative subdivision maps to the extent that each such period does not exceed one hundred fifty (150) days beyond the time otherwise provided by law, unless Landowner and City mutually agree to another time limit.

4.5 Limited Waiver of Protest Rights. In conjunction with any proceedings creating an assessment district or other applicable financing mechanism for which provision is made in this Agreement, Landowner waives herewith any right to protest which it may have under Section 2825 of the Streets and Highways Code to the extent that such protest would arise under Section 2825(a) through 2825(f) and Section 2825(h); but expressly retains the right of protest with respect to Section 2825(g).

4.6 Moratorium, Quotas, Restrictions or Other Growth Limitations. Subject to applicable law relating to the vesting provisions of development agreements, Landowner and City intend that, except as otherwise provided herein, this Agreement shall vest the Entitlements against subsequent City resolutions, ordinances and initiatives that directly or indirectly limit the rate, timing, sequencing of development, or prevent or conflict with the permitted uses, density and intensity of uses as set forth in the Entitlements. Landowner shall, to the extent allowed by the laws pertaining to development agreements, be subject to any growth limitation ordinance, resolution, rule, regulation or policy which is adopted on a uniformly applied, City-wide or area-wide basis and directly concerns a public health or safety issue, in which case City shall treat Landowner in a uniform, equitable and proportionate manner with all properties, public and private, which are impacted by that public health or safety issue. By way of example only, an ordinance which precluded the issuance of a building permit because City had inadequate sewage treatment capacity to meet the demand therefor (either City-wide or in a designated sub-area of the City) would directly concern a public health issue under the terms of this paragraph and would support a denial of a building permit within the Property, so long as City were also denying City-wide or area-wide all other requests for building permits which require sewage treatment capacity, however, an attempt to limit the issuance of building permits because of a general increase in traffic congestion levels in the City would not directly concern a public health or safety issue under the terms of this paragraph.

4.7 Essence of Agreement. The foregoing Sections 2, 3 and 4 are of the essence of this Agreement.

## **SECTION 5: DEFAULT, REMEDIES, TERMINATION**

5.1 General Provisions. Subject to extensions of time by mutual consent in writing, failure or unreasonable delay by either party to perform any term or provisions of this Agreement shall constitute a default. In the event of alleged default or breach of any term or condition of this Agreement, the party alleging such default or breach shall give the other party not less than thirty (30) days notice in writing specifying the nature of the alleged default and the manner in which said default may be satisfactorily cured. During any such thirty (30)-day period, the party charged shall not be considered in default for purposes of termination or institution of legal proceedings.

After notice and expiration of the thirty-day period, the other party to this Agreement at its option may institute legal proceedings pursuant to this Agreement or give notice of intent to terminate the Agreement pursuant to California Government Code Section 65868 and regulations of City implementing said Government Code Section. Following notice of intent to terminate, the matter shall be scheduled for consideration and review by the City Council within thirty (30) calendar days in the manner set forth in Government Code Sections 65865, 65867 and 65868 and City regulations implementing such Sections.

Following consideration of the evidence presented in said review before the City Council, either party alleging the default by the other party may give written notice of termination of this Agreement to the other party.

Evidence of default may also arise in the course of a regularly scheduled periodic review of this Agreement pursuant to Government Code Section 65865.1. If either party determines that the other party is in default following the completion of the normally scheduled periodic review, said party may give written notice of default of this Agreement as set forth in this section, specifying in said notice the alleged nature of the default, and potential actions to cure said default and shall specify a reasonable period of time in which such default is to be cured. If the alleged default is not cured within thirty (30) days or within such longer period specified in the notice, or if the defaulting party waives its right to cure such alleged default, the other party may terminate this Agreement.

No building permit shall be issued or building permit application accepted for any structure on the Property if the permit applicant owns and controls any property subject to this Agreement, and if such applicant or entity or person controlling such applicant is in default of the terms of this Agreement.

5.2 Annual Review. City shall, at least every twelve (12) months during the term of this Agreement, review the extent of good faith substantial compliance by Landowner with the terms of this Agreement. Such periodic review shall be limited in scope to compliance with the terms of this Agreement pursuant to Section 65865.1 of the Government Code and the monitoring of mitigation in accordance with Section 21081.6 of the Public Resources Code of the State of California. Notice of such annual review shall include the statement that any review of obligations of Landowner as set forth in this Agreement may result in termination of this

0202 0000 0007 0066

Agreement. A finding by City of good faith compliance by Landowner with the terms of the Agreement shall be conclusive with respect to the performance of Landowner during the period preceding the review. Landowner shall be responsible for the cost reasonably and directly incurred by the City to conduct such annual review, the payment of which shall be due within thirty (30) days after conclusion of the review and receipt from the City of the bill for such costs.

Upon not less than thirty (30) days written notice by the Planning Director of City, Landowner shall provide such information as may be reasonably requested and deemed to be required by the Planning Director in order to ascertain compliance with this Agreement.

In the same manner prescribed in Section 10, the City shall deposit in the mail to Landowner a copy of all staff reports and related exhibits concerning contract performance and, to the extent practical, at least ten (10) calendar days prior to any such periodic review. Landowner shall be permitted an opportunity to be heard orally or in writing regarding its performance under this Agreement before the City Council or if the matter is referred to the Planning Commission before said Commission.

If City takes no action within thirty (30) days following the hearing required under Roseville Municipal Code Section 19.94.080, or any successor thereof or amendment thereto, Landowner shall be deemed to have complied in good faith with the provisions of the Agreement.

5.3 Enforced Delay, Extension of Times of Performance. In addition to specific provisions of this Agreement, performance by either party hereunder shall not be deemed to be in default where delays or default are due to war, insurrection, strikes, walkouts, riots, floods, drought, earthquakes, fires, casualties, acts of God, governmental restrictions imposed or mandated by other governmental entities, enactment of conflicting state or federal laws or regulations, new or supplementary environmental regulation, litigation, or similar bases for excused performance. If written notice of such delay is given to City within thirty (30) days of the commencement of such delay, an extension of time for such cause shall be granted in writing for the period of the enforced delay, or longer as may be mutually agreed upon.

5.4 Legal Action. In addition to any other rights or remedies, either party may institute legal action to cure, correct or remedy any default, to enforce any covenant or agreement herein, or to enjoin any threatened or attempted violation. Provided, however, the sole remedy of City for any default of this Agreement by Landowner shall be to terminate this Agreement and the vesting of the Entitlements hereunder and to cease approving requests for development of the Property. All legal actions shall be initiated in the Superior Court of the County of Placer, State of California, or in the Federal District Court in the Eastern District of California.

5.5 Effect of Termination. If this Agreement is terminated following any event of default of Landowner or for any other reason, such termination shall not affect the validity of any building or improvement within the Property which is completed as of the date of termination, provided that such building or improvement has been constructed pursuant to a

0202 0000 0007 0067

building permit issued by the City. Furthermore, no termination of this Agreement shall prevent Landowner from completing and occupying any building or other improvement authorized pursuant to a valid building permit previously issued by the City that is under construction at the time of termination, provided that any such building or improvement is completed in accordance with said building permit in effect at the time of such termination.

5.6 Applicable Law and Attorneys' Fees. This Agreement shall be construed and enforced in accordance with the laws of the State of California. Should any legal action be brought by either party for breach of this Agreement or to enforce any provisions herein, the prevailing party to such action shall be entitled to reasonable attorneys' fees, court costs and such other costs as may be fixed by the Court.

## **SECTION 6: HOLD HARMLESS AGREEMENT**

Landowner and its successors-in-interest and assigns, hereby agrees to, and shall defend and hold City, its elective and appointive boards, commissions, officers, agents, and employees harmless from any liability for damage or claims for damage for personal injury, or bodily injury including death, as well as from claims for property damage which may arise from the operations of Landowner, or of Landowner's contractors, subcontractors, agents, or employees under this Agreement, whether such operations be by Landowner, or by any of Landowner's contractors or subcontractors, or by any one or more persons directly or indirectly employed by, or acting as agent for, Landowner or Landowner's contractors or subcontractors, unless such damage or claim arises from the negligence or willful misconduct of City. The foregoing indemnity obligation of Landowner shall not apply to any liability for damage or claims for damage with respect to any damage to or use of any public improvements after the completion and acceptance thereof by City. In addition to the foregoing indemnity obligation, Landowner agrees to and shall defend, indemnify and hold City, its elective and appointive boards, commissions, officers, agents and employees harmless from any suits or actions at law or in equity arising out of the execution, adoption or implementation of this Agreement, exclusive of any such actions brought by Landowner, its successors-in-interests or assigns. City acknowledges hereby that the foregoing liability of Landowner shall be limited to its interest in the Property and that neither Landowner nor any of its partners, officers, shareholders, employees or agents shall have any personal liability therefor.

## **SECTION 7: PROJECT AS A PRIVATE UNDERTAKING**

It is specifically understood and agreed by and between the parties hereto that the subject project is a private development. No partnership, joint venture or other association of any kind is formed by this Agreement.

0202 0000 0007 0008

## **SECTION 8: COOPERATION IN THE EVENT OF LEGAL CHALLENGE**

In the event of any legal action instituted by a third party or other governmental entity or official challenging the validity of any provision of this Agreement, the parties hereby agree to cooperate in defending said action.

## **SECTION 9: GENERAL**

9.1 Enforceability. The City agrees that unless this Agreement is amended or canceled pursuant to the provisions of this Agreement and the Adopting Ordinance, this Agreement shall be enforceable by any party hereto notwithstanding any change hereafter in any applicable general plan, specific plan, zoning ordinance, subdivision ordinance or building regulation adopted by City, or by initiative, which changes, alters or amends the rules, regulations and policies applicable to the development of the Property at the time of approval of this Agreement, as provided by Government Code Section 65866.

9.2 City Finding. The City hereby finds and determines that execution of this Agreement is in the best interest of the public health, safety and general welfare and is consistent with the General Plan.

9.3 Third Party Beneficiaries. This Agreement is made and entered into for the sole protection and benefit of the Landowner and the City and their successors and assigns. No other person shall have any right of action based upon any provision in this Agreement.

9.4 Severability. Except as set forth herein, if any term, covenant or condition of this Agreement or the application thereof to any person, entity or circumstance shall, to any extent, be invalid or unenforceable, the remainder of this Agreement, or the application of such term, covenant or condition to persons, entities or circumstances other than those as to which it is held invalid or unenforceable, shall not be affected thereby and each term, covenant or condition of this Agreement shall be valid and be enforced to the fullest extent permitted by law; provided, however, if any provision of this Agreement is determined to be invalid or unenforceable and the effect thereof is to deprive a party hereto of an essential benefit of its bargain hereunder, then such party so deprived shall have the option to terminate this entire Agreement from and after such determination.

9.5 Construction. This Agreement shall be subject to and construed in accordance and harmony with the Roseville Municipal Code, as it may be amended, provided that such amendments do not affect the rights granted to the parties by this Agreement.

9.6 Other Necessary Acts. Each party shall execute and deliver to the other all such other further instruments and documents as may be reasonably necessary to carry out this Agreement in order to provide and secure to the other party the full and complete enjoyment of its rights and privileges hereunder.

0202 0000 0007 0069

9.7 Estoppel Certificate. Either party may, at any time, and from time to time, deliver written notice to the other party requesting such party to certify in writing that, to the knowledge of the certifying party, (i) this Agreement is in full force and effect and a binding obligation of the parties, (ii) this Agreement has not been amended or modified either orally or in writing, or if so amended, identifying the amendments, and (iii) the requesting party is not in default in the performance of its obligations under this Agreement, or if in default, to describe therein the nature of such default. The party receiving a request hereunder shall execute and return such certificate within thirty (30) days following the receipt thereof. City acknowledges that a certificate hereunder may be relied upon by transferees and mortgagees of Landowner.

## **SECTION 10: NOTICES**

All notices required by this Agreement, the enabling legislation, or the procedure adopted pursuant to Government Code Section 65865, shall be in writing and delivered in person or sent by certified mail, postage prepaid.

Notice required to be given to the City shall be addressed as follows:

Planning Director  
City of Roseville  
316 Vernon Street, Room 104  
Roseville, CA 95678

Notice required to be given to the Landowner shall be addressed as follows:

Mourier Land Investment Corporation  
1830 Vernon Street, Suite 9  
Roseville, CA 95678  
Attention: John L. Mourier, III

Either party may change the address stated herein by giving notice in writing to the other party, and thereafter notices shall be addressed and transmitted to the new address.

**2. ASSIGNMENT**

Landowner shall have the full right to assign this Agreement as to the Property, or any portion thereof, in connection with any sale, transfer or conveyance thereof, and upon the express written assignment by Landowner and assumption by the assignee of such assignment in the form attached hereto as Exhibit "K" and the conveyance of Landowner's interest in the Property related thereto, Landowner shall be released from any further liability or obligation hereunder related to the portion of the Property so conveyed and the assignee shall be deemed to be the "Landowner," with all rights and obligations related thereto, with respect to such conveyed property.

**3. FORM OF AGREEMENT, EXHIBITS**

This Agreement is executed in two duplicate originals, each of which is deemed to be an original. This Agreement consists of forty one (41) pages and thirteen (13) exhibits, which constitute the entire understanding and agreement of the parties.

IN WITNESS WHEREOF, the City of Roseville, a municipal corporation, has authorized the execution of this Agreement in duplicate by its City Manager and attested to by its City Clerk under the authority of Ordinance No. 3358, adopted by the Council of the City of Roseville on the 2nd day of June, 1999, and "Landowner" has caused this Agreement to be executed.

CITY OF ROSEVILLE, a  
a municipal corporation

MOURIER LAND INVESTMENT  
CORPORATION, a California corporation

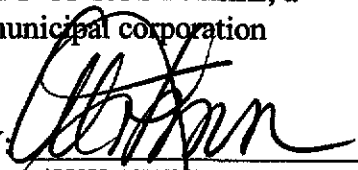
BY:   
ALLEN JOHNSON  
City Manager

By:   
John L. Mourier, III  
Its: **PRESIDENT**

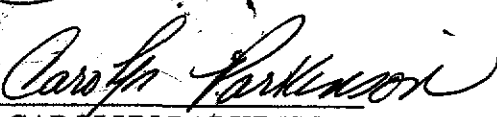
ATTEST:  
BY:   
CAROLYN PARKINSON  
City Clerk

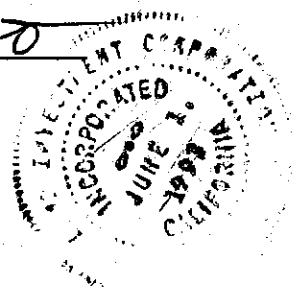

APPROVED AS TO FORM:

BY:   
MARK J. DOANE  
City Attorney

STATE OF CALIFORNIA )  
 )  
 ) ss.  
COUNTY OF PLACER )

On this 27 day of September in the year of 1999, before me, the undersigned, a Notary Public in and for said State, personally appeared Allen E. Johnson personally known to me (or proved on the basis of satisfactory evidence) to be the person(s) whose names is/are subscribed to the within instrument and acknowledged to me that he/she/they executed the same in his/her/their authorized capacity(ies), and that by his/her/their signature(s) on the instrument the person(s), or the entity upon behalf of which the person(s) acted, executed the instrument.

WITNESS my hand and official seal.

Carolyn Parkinson

Notary Public in and for said State



THIS CERTIFICATE MUST BE ATTACHED TO THE DOCUMENT DESCRIBED AS FOLLOWS:

Title or Type of Document Revel. Agmt.

Date of Document 9.22.99

**ALL-PURPOSE ACKNOWLEDGMENT**

STATE OF California  
COUNTY OF Placer

On September 17, 1999 before me, KAREN HEADLEY  
personally appeared John L. Mowner III  
personally known to me (or proved on the basis of satisfactory evidence) to be the person(s) whose name(s) is/are subscribed in the within instrument and acknowledged to me that he/she/they executed the same in his/her/their authorized capacity(ies), and that by his/her/their signature(s) on the instrument the person(s), or the entity upon behalf of which the person(s) acted, executed the instrument.

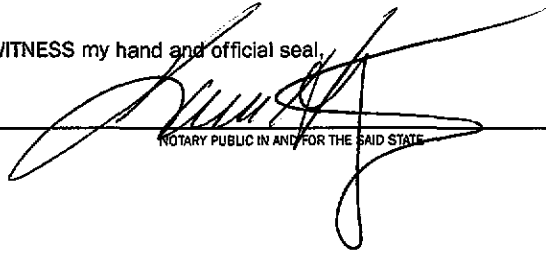
WITNESS my hand and official seal.  
  
NOTARY PUBLIC IN AND FOR THE SAID STATE



**CAPACITY CLAIMED BY SIGNER**  
NAME OF PERSON(S) OR ENTITY(IES)

- INDIVIDUAL(S)
- CORPORATE \_\_\_\_\_
- OFFICER(S) \_\_\_\_\_
- PARTNER(S)
- ATTORNEY-IN-FACT
- TRUSTEE(S)
- SUBSCRIBING WITNESS
- GUARDIAN/CONSERVATOR
- OTHER \_\_\_\_\_

**SIGNER IS REPRESENTING**  
NAME OF PERSON(S) OR ENTITY(IES)

\_\_\_\_\_  
\_\_\_\_\_  
\_\_\_\_\_  
\_\_\_\_\_  
\_\_\_\_\_  
\_\_\_\_\_  
\_\_\_\_\_

**ATTENTION NOTARY:** Although the information requested below is optional, it could prevent fraudulent attachment of this certificate to unauthorized document.

**THIS CERTIFICATE  
MUST BE ATTACHED  
TO THE DOCUMENT  
DESCRIBED AT THE RIGHT:**

Title or Type of Document \_\_\_\_\_  
Number of Pages \_\_\_\_\_  
Date of Document \_\_\_\_\_  
Signer(s) Other Than Named Above \_\_\_\_\_

This document is only a general form which may be proper for use in simple transactions and in no way acts, or is intended to act, as a substitute for the advice of an attorney. The printer does not make any warranty, either express or implied, as to the legal validity of any provision or the suitability of these forms in any specific transaction.



## LIST OF EXHIBITS

- Exhibit A-1 -- Legal Description of the Property
- Exhibit A-2 -- Diagram of the Property
- Exhibit B-1 -- Land Use Map for the Property
- Exhibit B-2 -- Land Use Table
- Exhibit C -- General Location of Bike Trail Improvements
- Exhibit D -- On-Site Electric Distribution Facilities
- Exhibit E -- [Reserved]
- Exhibit F -- On-Site Water Lines
- Exhibit G -- Recycled Water Lines
- Exhibit H -- Sewer Lines
- Exhibit H-1 -- On-Site and Off-Site Sewer Systems
- Exhibit I -- Collector Streets
- Exhibit I-1 -- Proposed Fiddymment Road Realignment
- Exhibit J -- CFD Improvements
- Exhibit K -- Form of Assignment

0202 0000 0007 0074

## Exhibit A-1

Mourier 160

All that real property situate in the City of Roseville, County of Placer, State of California being all of the Southeast One-quarter of Section 18, Township 11 North, Range 6 East as delineated on that Record of Survey, prepared by Spannagel and Associates and filed for record in the office of the Recorder of said County in Book 13, at Page 18, described as follows:

Beginning at the Southeast corner of said Section 18; thence from said Point of Beginning along the south line of said Section 18, South  $89^{\circ}06'12''$  West, 2645.96 to the South One-Quarter corner of said Section 18; thence along the West line of the Southeast One-quarter of said Section 18, North  $00^{\circ}14'10''$  West, 2648.22 feet to the center of said Section 18; thence along the North line of the Southeast One-quarter of Section 18, North  $89^{\circ}05'29''$  East, 2641.77 feet to the West One-Quarter corner of said Section 18; thence along the East line of said Section 18, South  $00^{\circ}19'37''$  East, 2648.72 feet to the Point of Beginning containing 160.74 acres, more or less.

# Exhibit A-2

## Mourier 160

The Southeast One-quarter of  
Section 18, T 11 N, R 6 E, M.B.M.

City of Roseville, State of California  
Scale 1" = 500'

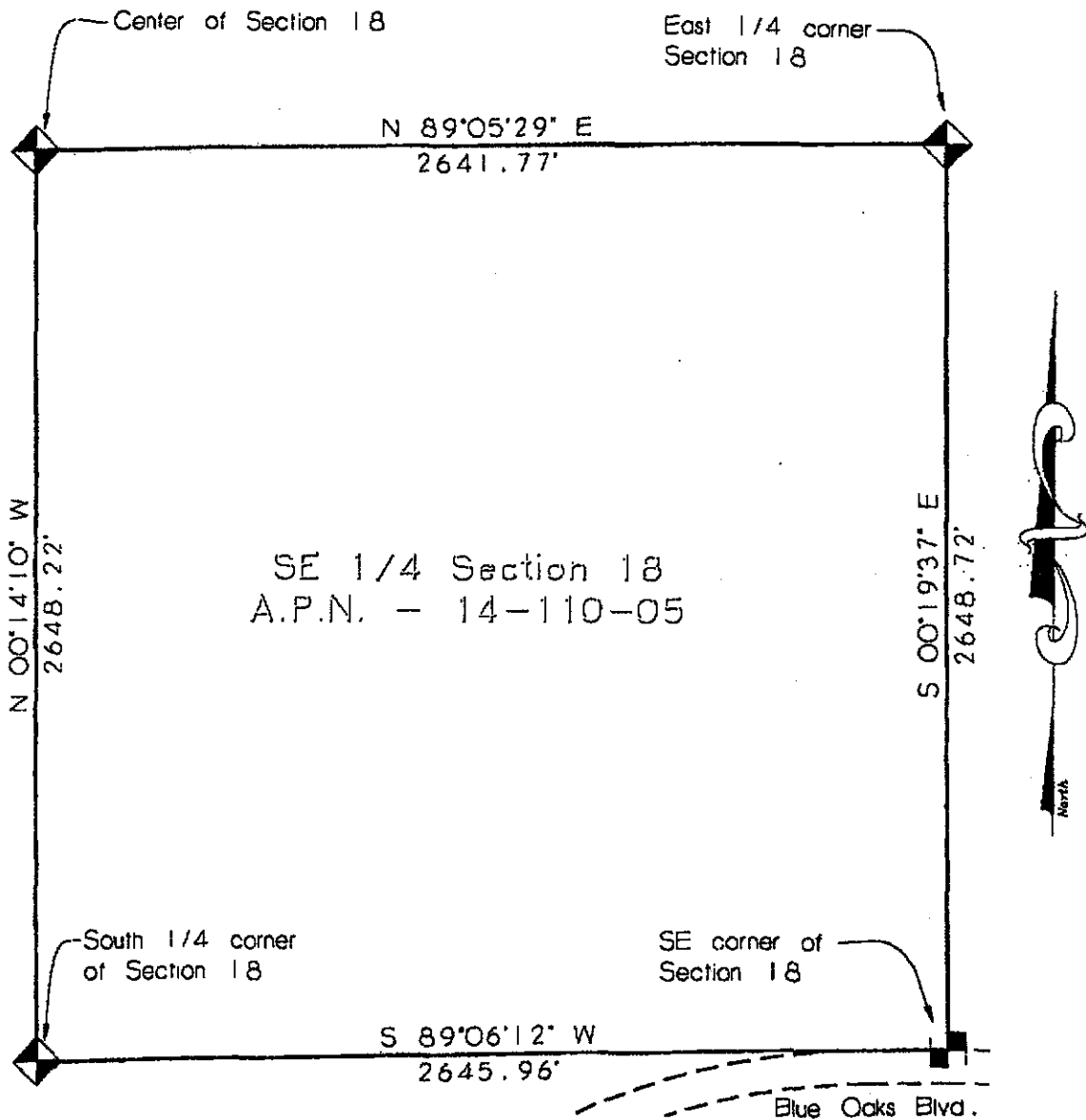

94018

20161 A-2.dwg 0 13-99 1:32:15 pm 7/01

**KB** ENGINEERING  
SURVEYING  
PLANNING

**KENT BAKER & ASSOCIATES**  
7996 California Ave., Suite 'C' (916) 967-7053  
Fair Oaks, California 95628-7140 Fax 967-4260

0202 0000 0007 5075

EXHIBIT B

**EXHIBIT "B" - 1**  
**Mourier 160**  
**Land Uses for the Property**

**Mourier 160**  
**Land Use**

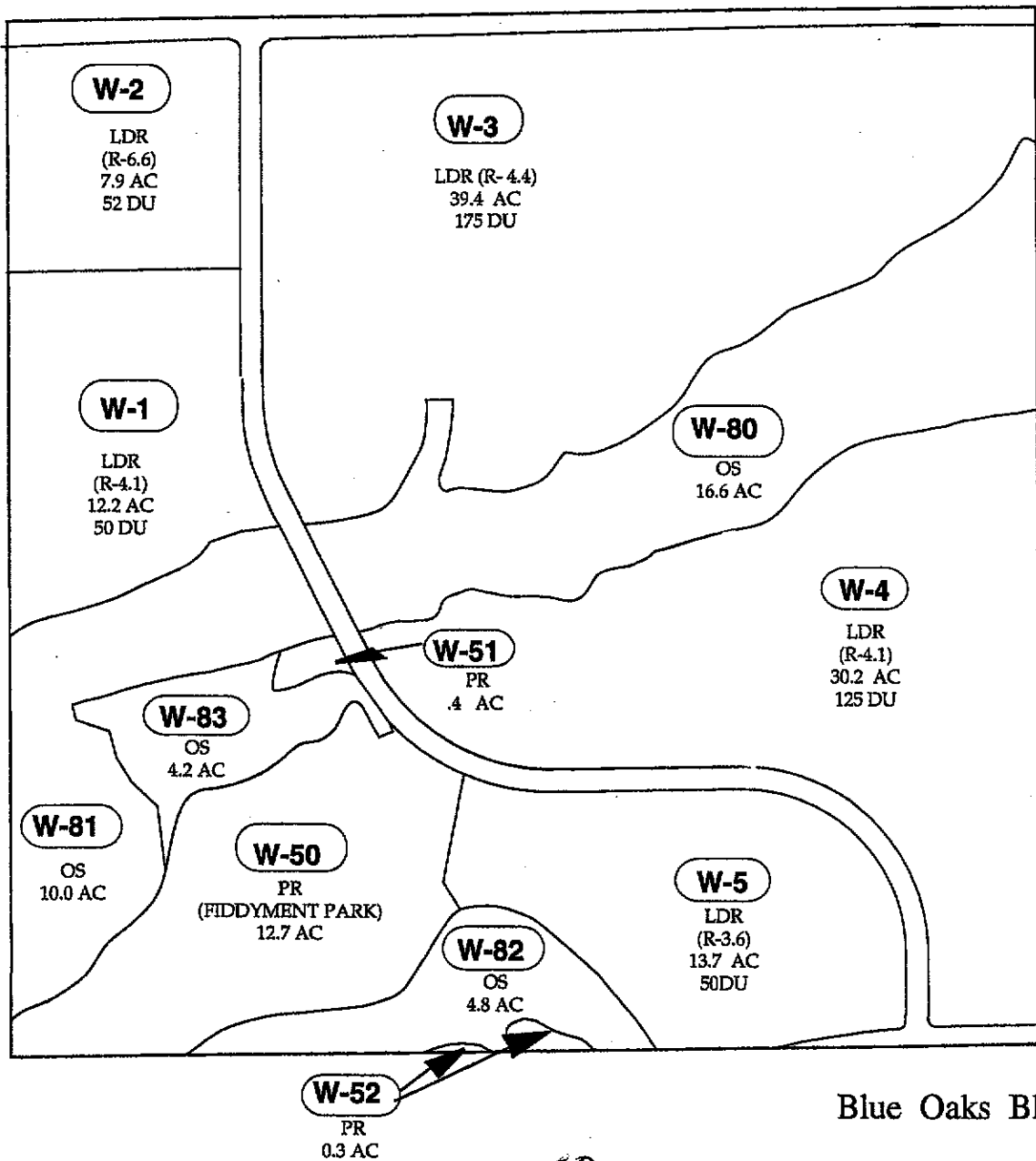

50

0202 0000 0007 0077

**EXHIBIT "B"-2**

Mourier 160

Land Uses for the Property

<b>Mourier 160</b>						
<b>Land Use by Parcel Table</b>						
<i>Parcel</i>	<i>Zoning</i>	<i>Land Use</i>	<i>Density</i>	<i>Net Acreage</i>	<i>Units</i>	
W-1	R1/DS	LDR	4.1	12.2	50	
W-2	RS/DS	LDR	6.6	7.9	52	
W-3	R1/DS	LDR	4.4	39.4	175	
W-4	R1/DS	LDR	4.1	30.2	125	
W-5	R1/DS	LDR	3.6	13.7	50	
W-50	PR	Park		12.7		
W-51	PR	Park		0.4		
W-52	PR	Park		0.3		
W-80	OS	Open Space		16.6		
W-81	OS	Open Space		10.0		
W-82	OS	Open Space		4.8		
W-83	OS	Open Space		4.2		
		ROW - Mourier 160		8.6		
				<b>161.0</b>	<b>452</b>	



**EXHIBIT "D"**  
Mourier 160  
Electric Service

NOTE: 12kv may be extended if road is constructed as a collector.  
(See Section 3.9.4)

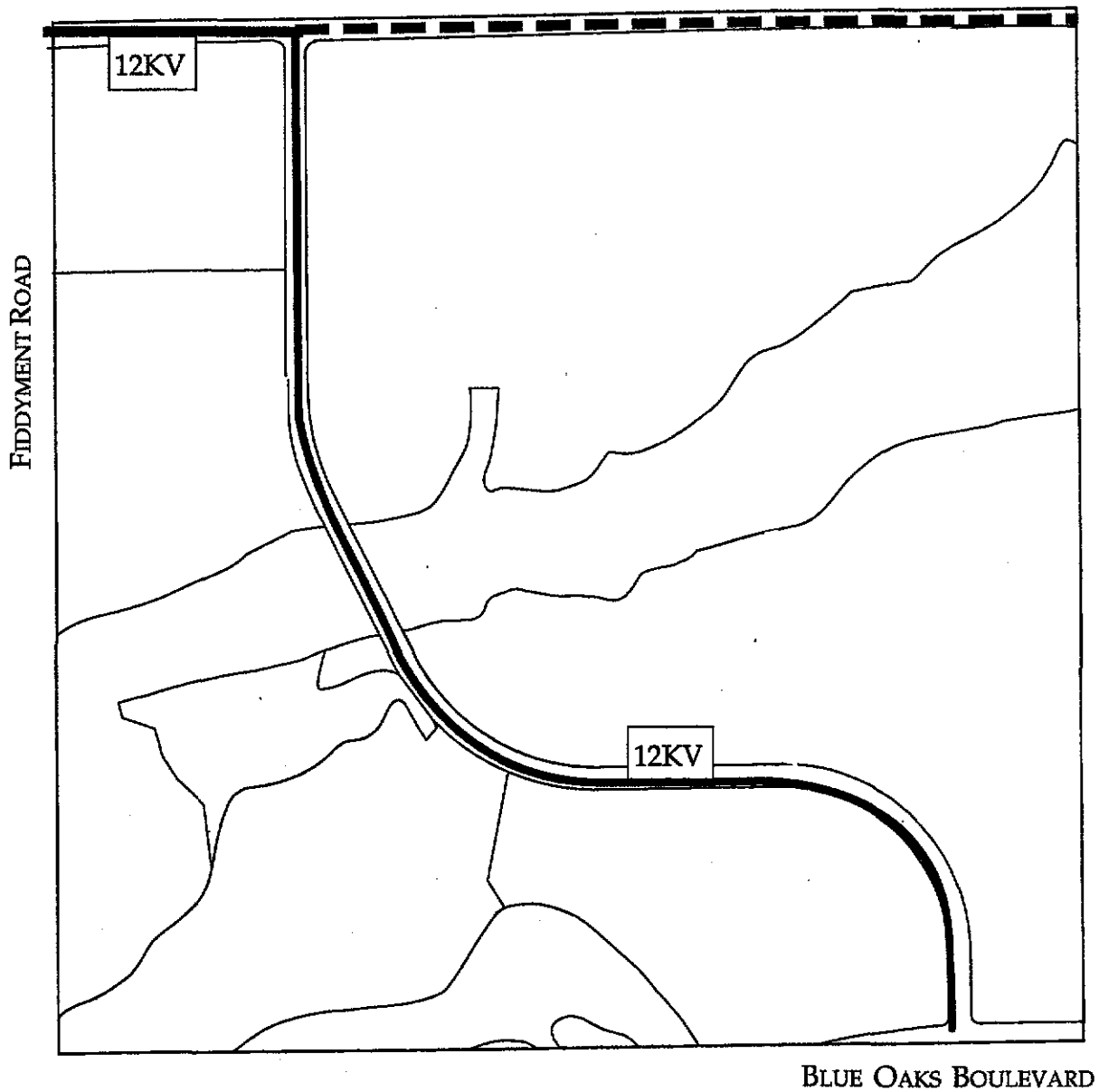

0202 0000 0007 0080



**EXHIBIT "F"**  
**Mourier 160**  
**On Site Water Lines**

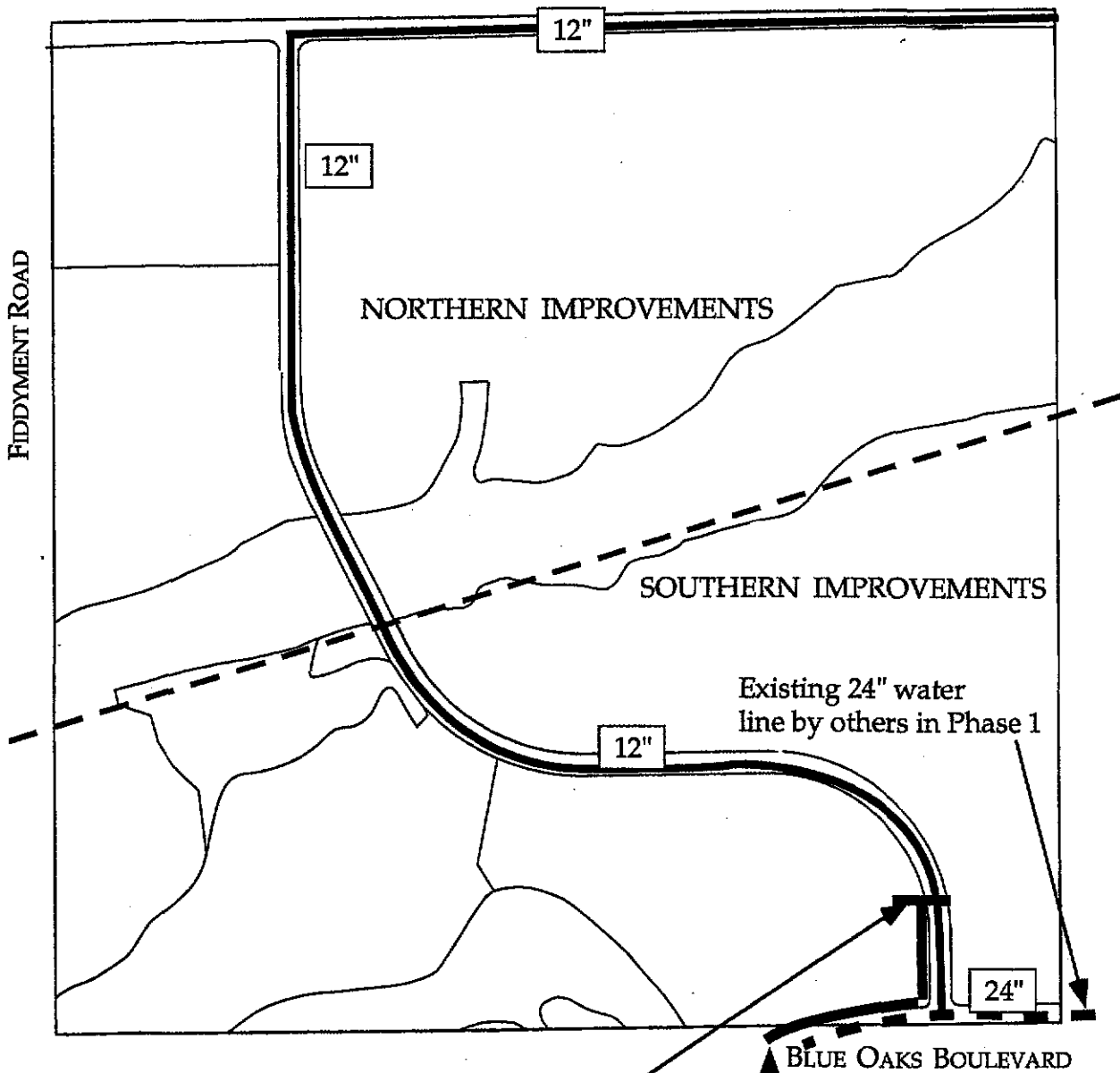

Alternate water system loop with 12" parallel water extending from existing 16" in Blue Oaks Blvd. to first cross street on Collector N north of Blue Oaks Blvd.

0202 0000 0007 0081



**EXHIBIT "G"**  
Mourier 160  
Recycled Water Lines

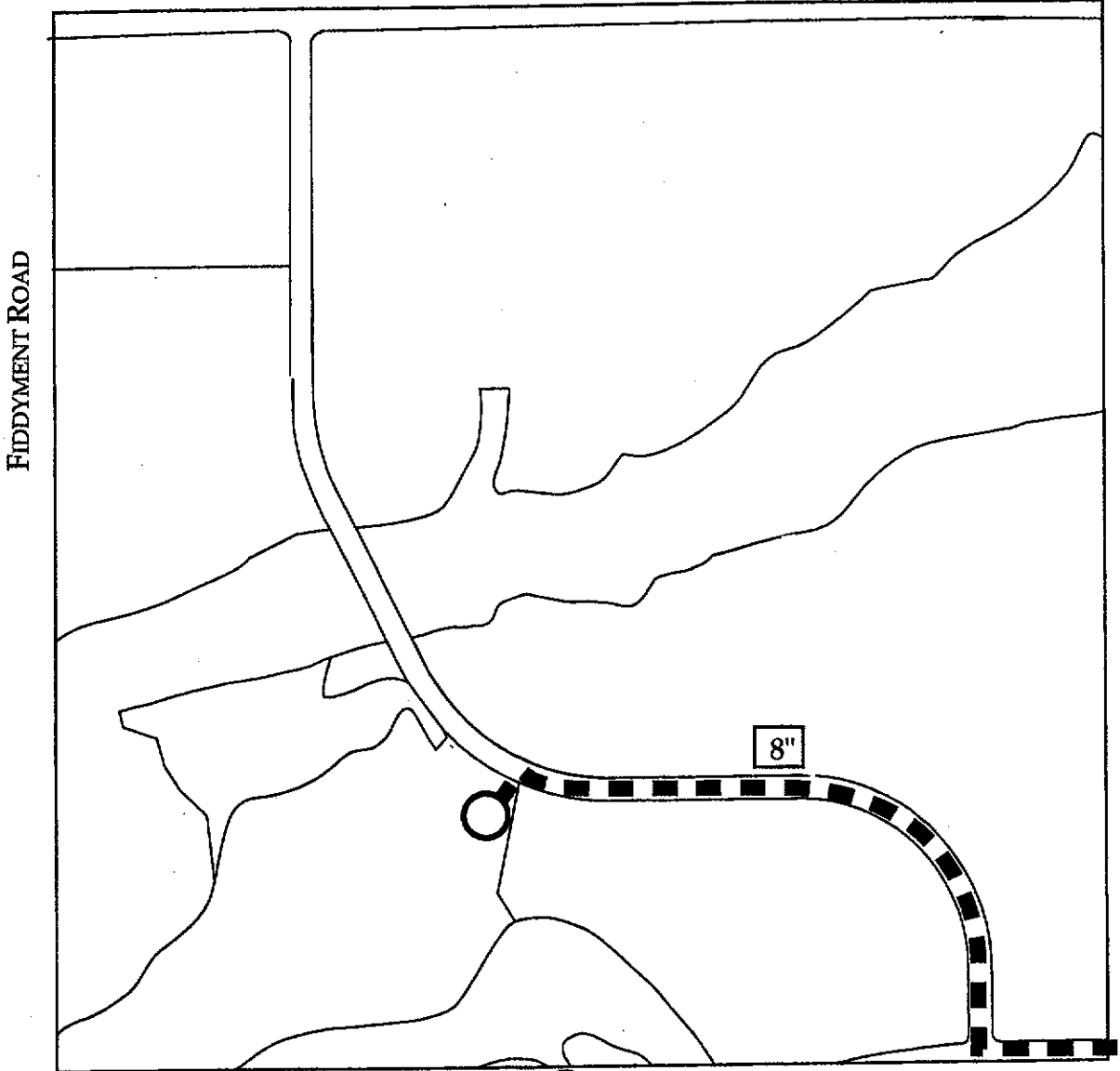

Existing Recycled  
Water Line in Blue Oaks Park

BLUE OAKS BOULEVARD

55

0202 0000 0007 0082



**EXHIBIT "H"**  
**Mourier 160**  
**On Site Sewer Lines**

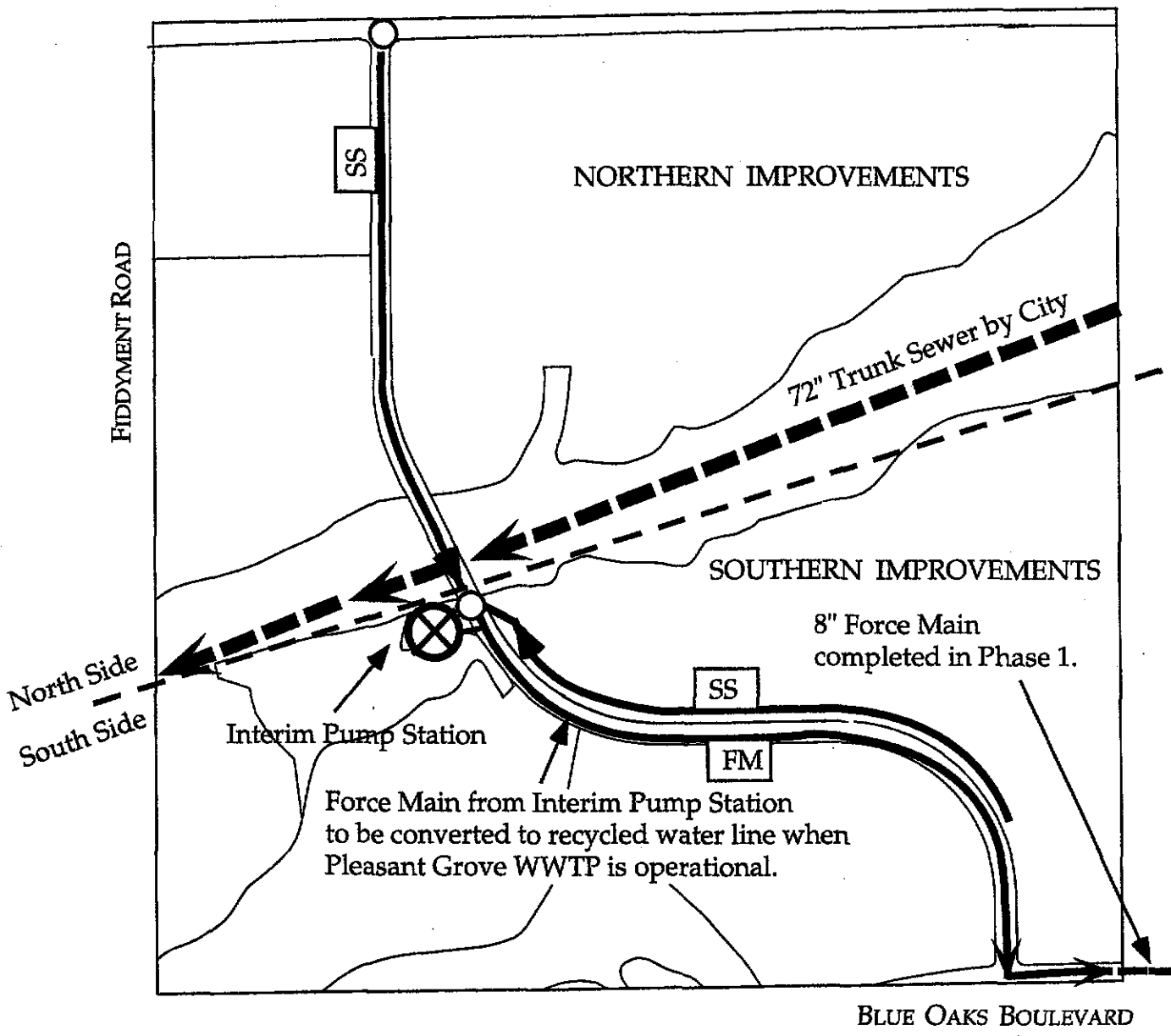

NOTE: Sewer line sizes to be determined in the Wastewater Master Plan.

0202 0000 0007 0083





**EXHIBIT "H-1"**  
**Mourier 160**  
**On-site and Off-site Sewer System**

**KEY**

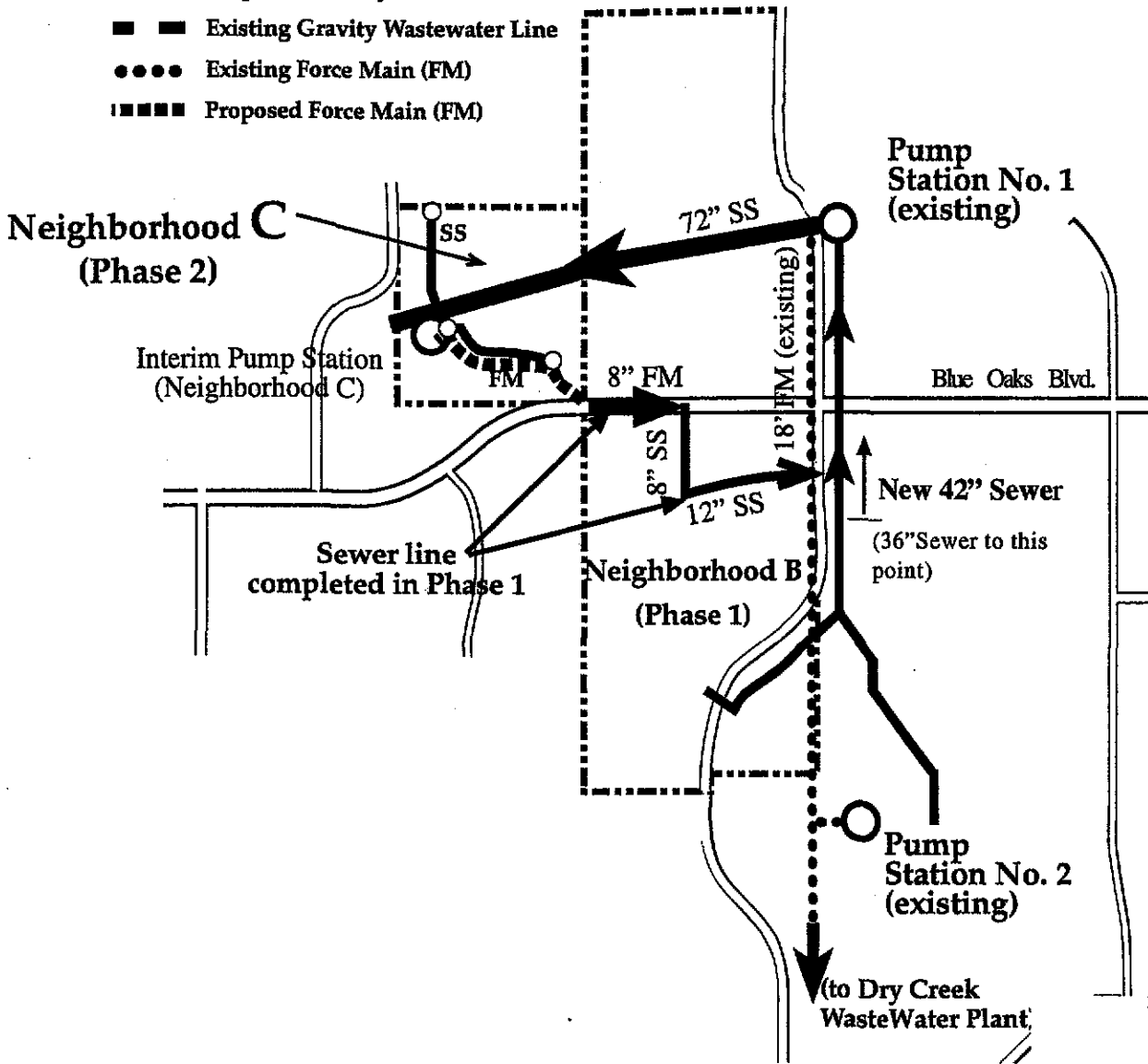
- Specific Plan Boundary
- Proposed Gravity Wastewater Line (SS)
- Existing Gravity Wastewater Line
- Existing Force Main (FM)
- ■ ■ ■ Proposed Force Main (FM)



**EXHIBIT "I"**  
Mourier 160  
Streets

 Existing Roads  
 Future Roads

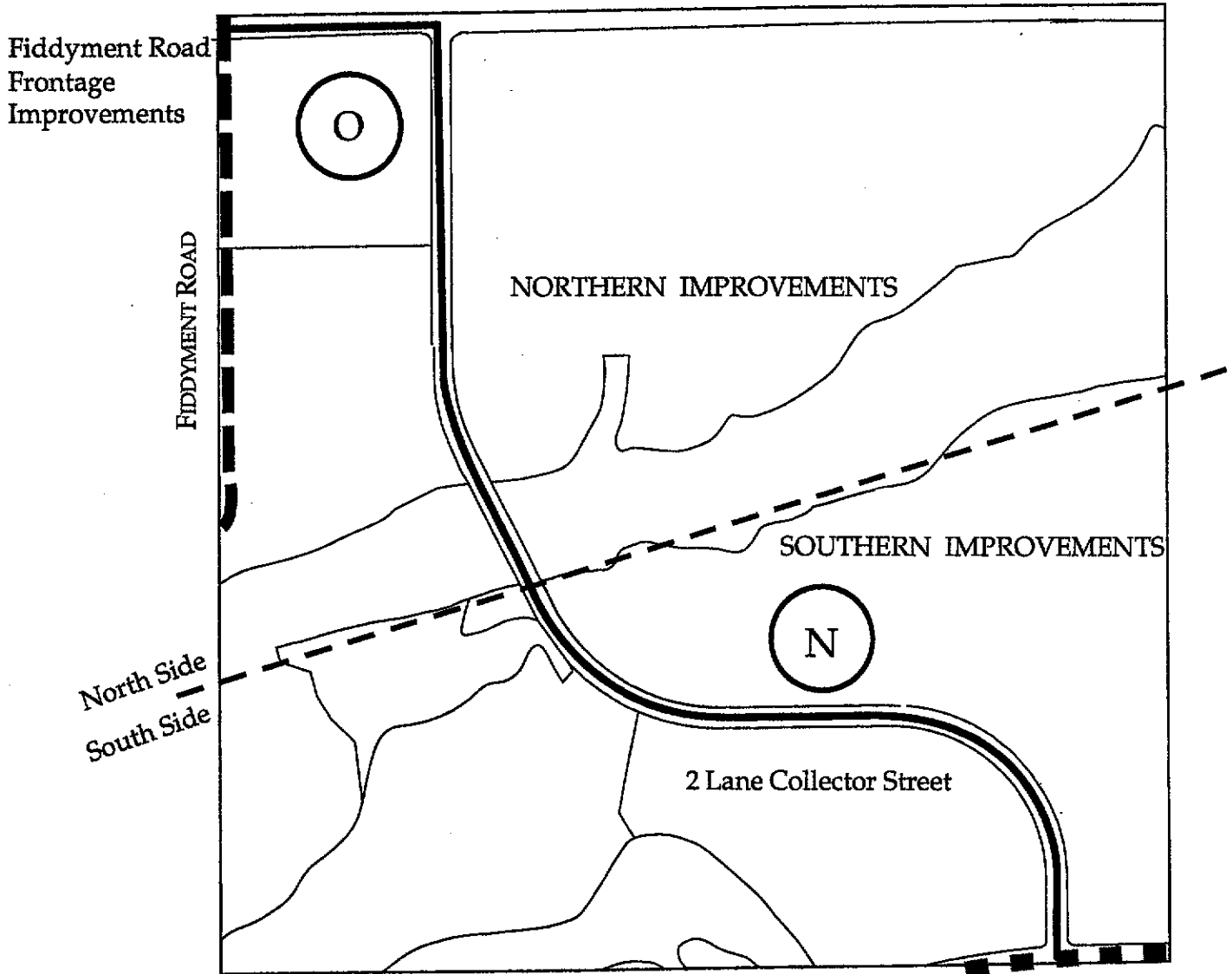

NOTE: Collector O may be extended as a collector to the eastern boundary of property. (See Section 3.9.4)

BLUE OAKS BOULEVARD  
Frontage Improvements

0202 0000 0007 0085



**EXHIBIT "I-1"**  
Mourier 160  
Fiddymment Road Alignment Placer Co.  
Alternative

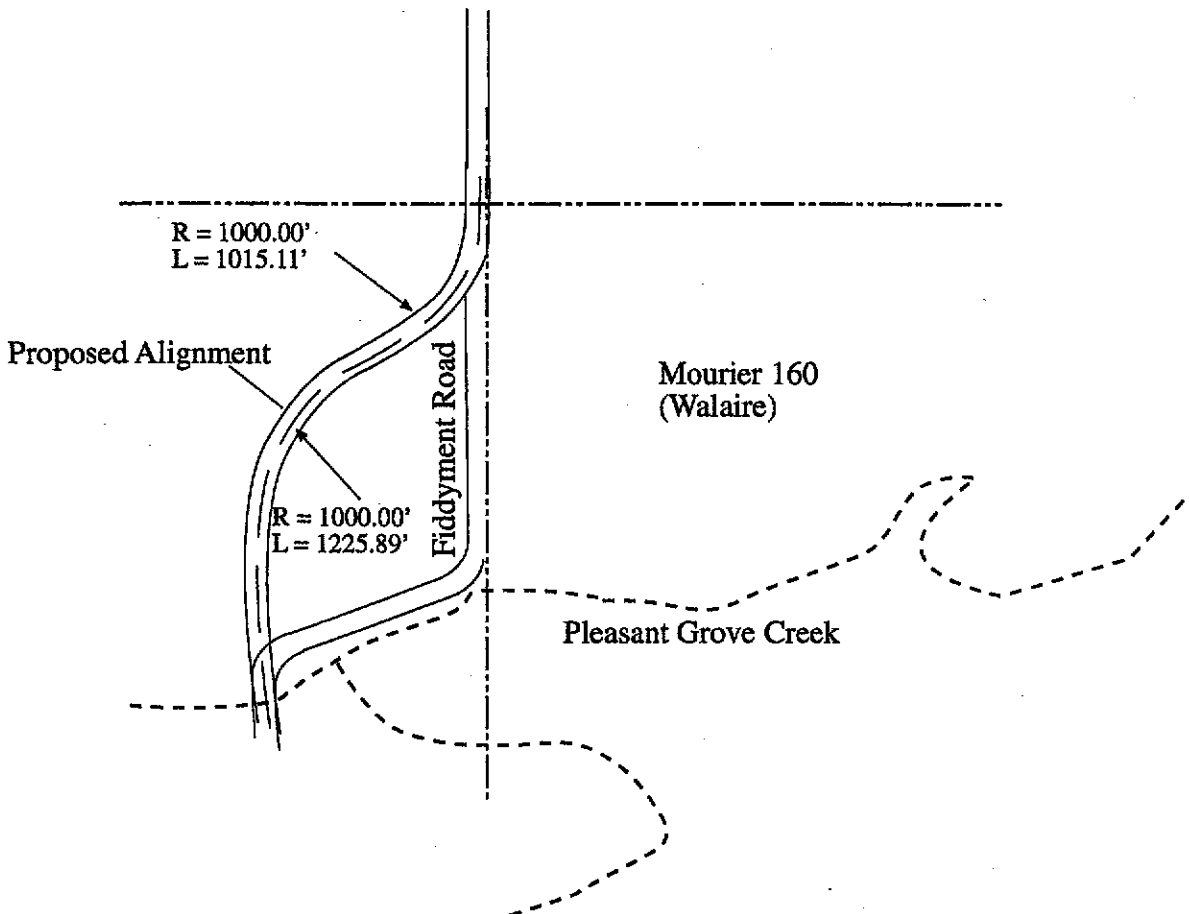

**EXHIBIT "J"**

**CFD IMPROVEMENTS**

**CFD FACILITIES**

**✕ ROADS**

**☐ Blue Oaks Boulevard**

- ! Frontage improvements on the north side of Blue Oaks Boulevard, consisting of curb, gutter, 18 feet of pavement, streetlights, utilities and ancillary improvements, plus median landscaping. Road improvements will extend along boundary of Property adjacent to Blue Oaks Boulevard, with appropriate transitions at each end.

**☐ Fiddymment Road**

- ! \$304,403, representing the agreed-upon Landowner cost for improvements along the portion of the current alignment for Fiddymment Road adjacent to the Plan Area north of Blue Oaks Boulevard, plus the cost of demolition of the existing improvements for such portion of Fiddymment Road. Funds will be used to construct Fiddymment Road improvements in either its current alignment or pending realignment.

**☐ Collector Streets**

- ! Curb, gutter, pavement, streetlights, utilities, bridge (for Collector N) and ancillary improvements for Collectors N and O.
  - Sidewalk to be located back-of-curb for the portion of Collector N adjacent to open space, as required by City.
- ! Curb, gutter, pavement, streetlights, utilities, and ancillary improvements for the street along the northern boundary of the Plan Area from the intersection of Collectors N and O to the eastern Plan Area boundary, if constructed as a Collector Street, as may be approved by the City, as shown on Exhibit "I".

**☐ Intersections**

- ! Intersection improvements (excluding signals, but including conduit and sleeves therefor) as required by the City for the intersections of Blue Oaks Boulevard and Collector N, and Fiddymment Road and Collector O.

**☐ Additional Improvements**

0202 0000 0007 0087 *leO*

! In addition to the required sidewalk along non-park, open space described above, at Landowner's option, the CFD may include financing for additional sidewalk for some or all of the above roads.

**✕ DRAINAGE**

- Master Drainage Plan.
- Storm drain mains required by the Master Drainage Plan and laterals located within the above-described road improvements.

**✕ WATER**

- Water Study.
- All on-site improvements to the water system required by the Water Study, as generally shown on Exhibit "F" of this Agreement.

**✕ RECYCLED WATER**

- Recycled water line extension from the City's backbone system in Blue Oaks Boulevard to the publicly owned park within the Plan Area, as generally shown on Exhibit "G" of this Agreement.

**✕ SEWER**

- Master Wastewater Plan.
- All on-site improvements to the sewer system required by the Master Wastewater Plan, as generally shown on Exhibit "H" to this Agreement, except for the 72" Trunk Sewer to be located within the Plan Area, which shall be the City's responsibility.

**✕ ELECTRIC FACILITIES**

- All on-site electric distribution facilities identified in Exhibit "D" of this Agreement and within the street along the northern boundary of the Plan Area from the intersection of Collectors N and O to the eastern Plan Area boundary, if such street is constructed as a Collector.

**✕ MITIGATION COSTS**

- Wetland or other environmental mitigation costs related to any public improvement to be installed within the Plan Area, including without limitation, preserve fencing.

**CFD CONTRIBUTIONS**

**✕ CIRBY RIVERSIDE**

0202 0000 0007 0088

- \$55,111 at bond issuance to be used by City for improvements to the Cirby and Riverside intersection, to be credited against the City Traffic Mitigation Fee.

**✕ PARK**

- \$99,527 for Little League improvements to be installed by City within Mahany Park.
- At Landowners' option, up to \$298,581 for City construction of Citywide Park Facilities, to be credited against the City's Citywide Park Fee.

0202 0000 0007 0089

**EXHIBIT "K"**

When Recorded, Return to:

[Name of Landowner]

Attn: \_\_\_\_\_

**ASSIGNMENT AND ASSUMPTION AGREEMENT  
RELATIVE TO  
NORTH ROSEVILLE DEVELOPMENT AGREEMENT  
(Village \_\_\_\_)**

THIS ASSIGNMENT AND ASSUMPTION AGREEMENT (hereinafter, the "Agreement") is entered into this \_\_\_\_ day of \_\_\_\_\_, 199\_\_, by and between [NAME OF LANDOWNER], a \_\_\_\_\_ (hereinafter "Developer"), and [NAME OF PURCHASER], a \_\_\_\_\_ (hereinafter "Assignee").

**RECITALS**

A. On \_\_\_\_\_, 199 , the City of Roseville and Developer entered into that certain agreement entitled "Development Agreement By and Between The City of Roseville and [Name of Landowner] Relative to the North Roseville Specific Plan" (hereinafter the "Development Agreement"), pursuant to which Developer agreed to develop certain property more particularly described in the Development Agreement (hereinafter "the Subject Property"), subject to certain conditions and obligations as set forth in the Development Agreement. The Development Agreement was recorded against the Subject Property in the Official Records of Placer County on \_\_\_\_\_, 199 in Book \_\_\_\_\_, Page \_\_\_\_\_, Series No. \_\_\_\_\_.

B. Developer intends to convey a portion of the Subject Property to Assignee, as identified and described in Exhibit A, attached hereto and incorporated herein by this reference (hereinafter the "Assigned Parcel(s)").

C. Developer desires to assign and Assignee desires to assume all of Developer's right, title, interest, burdens and obligations under the Development Agreement with respect to and as related to the Assigned Parcel(s).

**ASSIGNMENT AND ASSUMPTION**

NOW, THEREFORE, Developer and Assignee hereby agree as follows:

1. Developer hereby assigns, effective as of Developer's conveyance of the Assigned Parcel(s) to Assignee, all of the rights, title, interest, burdens and obligations of Developer under the Development Agreement with respect to the Assigned Parcel(s). Developer retains all the rights, title, interest, burdens and obligations under the Development Agreement with respect to all other property within the Subject Property owned by Developer.

2. Assignee hereby assumes all of the rights, title, interest, burdens and obligations of Developer under the Development Agreement with respect to the Assigned Parcel(s), and agrees to observe and fully perform all of the duties and obligations of Developer under the Development Agreement with respect to the Assigned Parcel(s), and to be subject to all the terms and conditions thereof with respect to the Assigned Parcel(s). The parties intend hereby that, upon the execution of this Agreement and conveyance of the Assigned Parcel(s) to Assignee, Assignee shall become substituted for Developer as the "Developer" under the Development Agreement with respect to the Assigned Parcel(s).

3. All of the covenants, terms and conditions set forth herein shall be binding upon and shall inure to the benefit of the parties hereto and their respective heirs, successors and assigns.

4. The Notice Address described in Section 10 of the Development Agreement for the Developer with respect to the Assigned Parcel(s) shall be:

[Name of Assignee]

\_\_\_\_\_

Attn: \_\_\_\_\_

IN WITNESS HEREOF, the parties hereto have executed this Agreement as of the day and year first above written. This Agreement may be signed in identical counterparts.

**ASSIGNEE:**

[NAME OF ASSIGNEE],

a \_\_\_\_\_

By: \_\_\_\_\_

Name: \_\_\_\_\_

Its: \_\_\_\_\_

**DEVELOPER:**

[NAME OF LANDOWNER],

a \_\_\_\_\_

By: \_\_\_\_\_

Name: \_\_\_\_\_

Its: \_\_\_\_\_

ORDINANCE NO. 3358

ORDINANCE OF THE COUNCIL OF THE CITY OF ROSEVILLE  
ADOPTING A DEVELOPMENT AGREEMENT REGARDING NORTH ROSEVILLE  
SPECIFIC PLAN PHASE II (MOURIER LAND INVESTMENT),  
AND AUTHORIZING THE CITY MANAGER TO  
EXECUTE IT ON BEHALF OF THE CITY OF ROSEVILLE

THE CITY OF ROSEVILLE ORDAINS:

SECTION 1. In accordance with Chapter 19.84 of Title 19 of the Roseville Municipal Code (the Zoning Ordinance) of the City of Roseville, the City Council has received the recommendation of the Planning Commission that the City of Roseville enter into a Development Agreement with Mourier Land Investment.

SECTION 2. The Council of the City of Roseville has reviewed the findings of the Planning Commission recommending approval of the Development Agreement, and makes the following findings:

1. The Development Agreement is consistent with the objectives, policies, general land uses and programs specified in the City of Roseville General Plan and the North Roseville Specific Plan;
2. The Development Agreement is consistent with the City of Roseville Zoning Ordinance and Zoning Map;
3. The Development Agreement is in conformance with the public healthy, safety and welfare;
4. The Development Agreement will not adversely affect the orderly development of the property or the preservation of property values; and
5. The Development Agreement will provide sufficient benefit to the City to justify entering into said Agreement;

SECTION 3. The Development Agreement by and between Mourier Land Investment and the City of Roseville, a copy of which is on file in the City Clerk's Department and incorporated herein by reference, is hereby approved and the City Manager is authorized to execute it on behalf of the City of Roseville.

SECTION 4. The City Clerk is directed to record the executed Development Agreement within ten (10) days of the execution of the agreement by the City Manager with the County Recorder's office of the County of Placer.

**SECTION 5.** This ordinance shall be effective at the expiration of thirty (30) days from the date of its adoption.

**SECTION 6.** The City Clerk is hereby directed to cause this ordinance to be published in full at least once within fourteen (14) days after it is adopted in a newspaper of general circulation in the City, or shall within fourteen (14) days after its adoption cause this ordinance to be posted in full in at least three public places in the City and enter in the Ordinance Book a certificate stating the time and place of said publication by posting.

PASSED AND ADOPTED by the Council of the City of Roseville this 2nd day of June, 1999, by the following vote on roll call:

AYES COUNCILMEMBERS: Earl Rush, Dan Goodhall, Randolph Graham, Harry Crabb

NOES COUNCILMEMBERS: None

ABSENT COUNCILMEMBERS: Claudia Gamar

  
MAYOR

ATTEST:

  
City Clerk

The foregoing instrument is a correct copy of the original on file in the City Clerks Department.

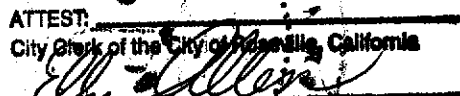
ATTEST:  
City Clerk of the City of Roseville, California  
  
DEPUTY CLERK

